

Specifications

Nominal Voltage		12 V
Number of cell		6 cells
Capacity(20HR, 25°C)		18 Ah
Capacity(15min.rate, 25°C)		76 Watts/cell
Dimension	Length	181±2mm (7.13inch)
	Width	77±1mm (3.03inch)
	Height	167±2mm (6.57inch)
	Total Height	167±2mm (6.57inch)
Approx. Weight		5.7kg (12.6lbs)±4%
Terminal type		T3/T8
Internal resistance (Fully charged, 25°C)		Approx. 12mΩ
Capacity affected by temperature (20HR)	40°C	102%
	25°C	100%
	0°C	85%
	-15°C	65%
Self-discharge (25°C)	3 month	Remaining Capacity: 91%
	6 month	Remaining Capacity: 82%
	12 month	Remaining Capacity: 65%
Nominal operating temperature		25°C ± 3°C (77°F ± 5°F)
Operating temperature range	Discharge	-15°C ~ 50°C (5°F ~ 122°F)
	Charge	-10°C ~ 50°C (14°F ~ 122°F)
	Storage	-20°C ~ 50°C (-4°F ~ 122°F)
Float charging voltage(25°C)		13.60 to 13.80V Temperature compensation: -18mV/°C
Cyclic charging voltage(25°C)		14.50 to 14.90V Temperature compensation: -30mV/°C
Maximum charging current		5.4A
Terminal material		Copper
Maximum discharge current		270A(5 sec.)
Designed floating life(20°C)		3~5 years

- ◆ Absorbent glass mat technology;
- ◆ Recognized by UL & CE;
- ◆ ABS container.

Dimensions

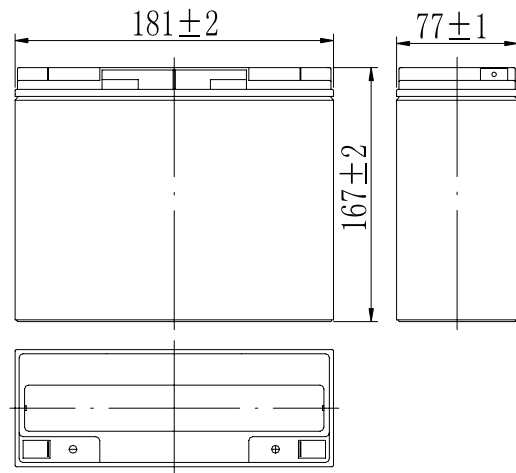

Terminal

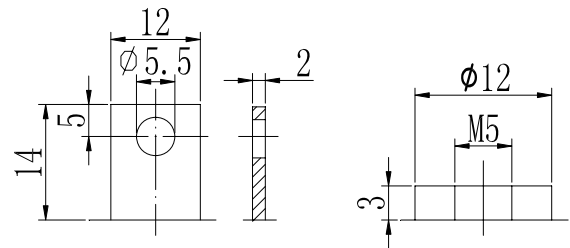

Terminal T3

Terminal T8

Constant Current Discharge Characteristics (A, 25°C)

F.V/TIME	10min	15min	20min	30min	45min	60min	2h	3h	5h	10h	20h
1.60V/cell	51.0	40.2	31.9	22.1	15.8	12.5	6.58	4.68	3.21	1.74	0.93
1.65V/cell	49.5	39.2	31.1	21.6	15.5	12.3	6.54	4.65	3.19	1.73	0.93
1.67V/cell	48.7	38.6	30.6	21.4	15.3	12.2	6.52	4.64	3.18	1.73	0.93
1.70V/cell	47.5	37.8	30.0	21.0	15.0	12.0	6.48	4.62	3.17	1.72	0.92
1.75V/cell	45.4	36.5	28.9	20.5	14.7	11.8	6.38	4.59	3.15	1.71	0.92
1.80V/cell	42.9	34.6	27.4	19.7	14.1	11.4	6.22	4.45	3.06	1.68	0.90

Constant Power Discharge Characteristics (Watt/cell, 25°C)

F.V/TIME	10min	15min	20min	30min	45min	60min	2h	3h	5h	10h	20h
1.60V/cell	98.5	79.2	62.8	43.5	31.2	24.6	13.0	9.36	6.43	3.47	1.86
1.65V/cell	95.5	77.3	61.3	42.6	30.6	24.2	12.9	9.31	6.39	3.46	1.86
1.67V/cell	94.0	76.0	60.3	42.1	30.2	24.0	12.9	9.28	6.37	3.45	1.85
1.70V/cell	91.6	74.4	59.0	41.3	29.6	23.6	12.8	9.24	6.34	3.44	1.85
1.75V/cell	87.6	71.9	57.0	40.3	28.9	23.2	12.6	9.18	6.30	3.42	1.84
1.80V/cell	82.7	68.1	54.0	38.8	27.8	22.5	12.3	8.90	6.11	3.35	1.80

Note: The above characteristics data can be obtained within three charge/discharge cycles.

Discharge Characteristics(25°C)

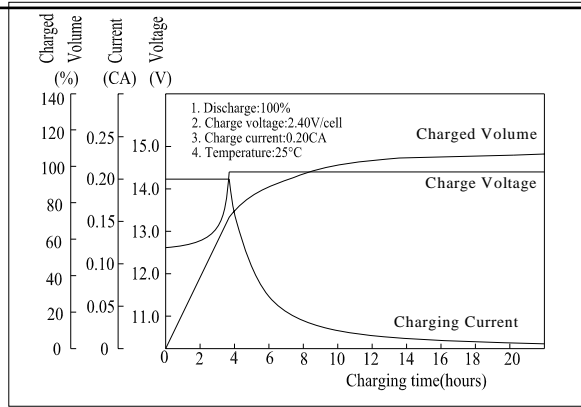
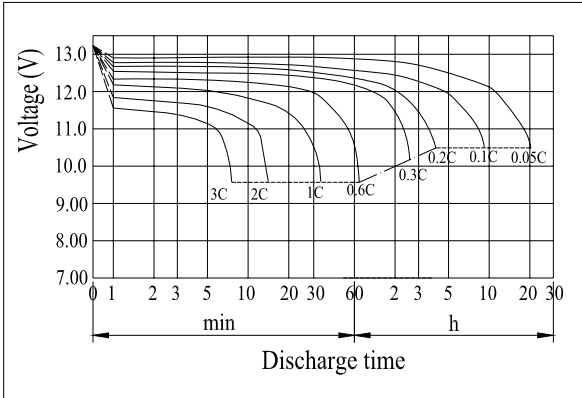

Effect of Temperature on Capacity

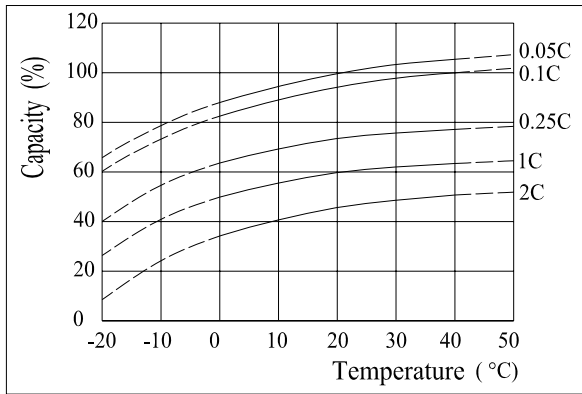

Self-discharge Characteristics

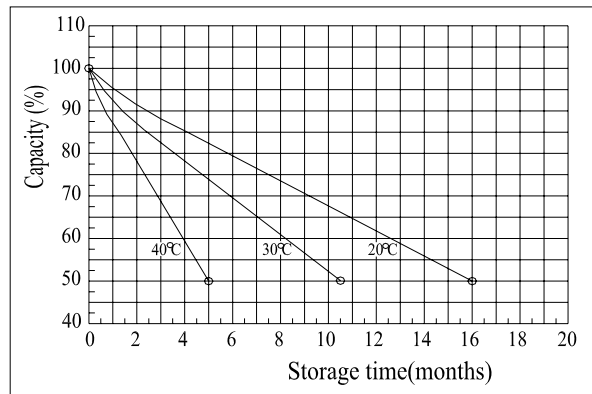

The Relationship for Open Circuit Voltage and Residual Capacity (25°C)

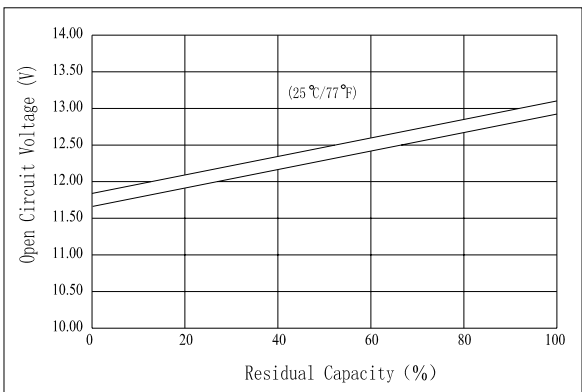

The Relationship for Charging Voltage and Temperature

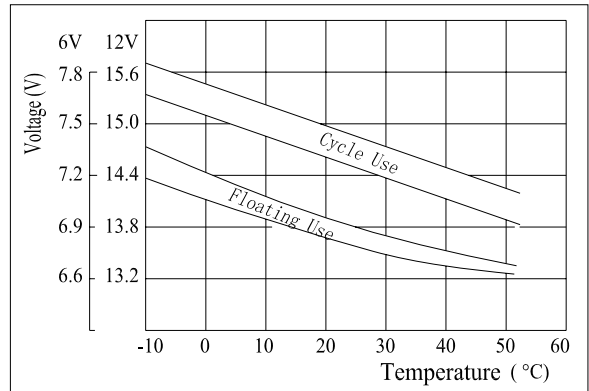

Floating Life on Temperature

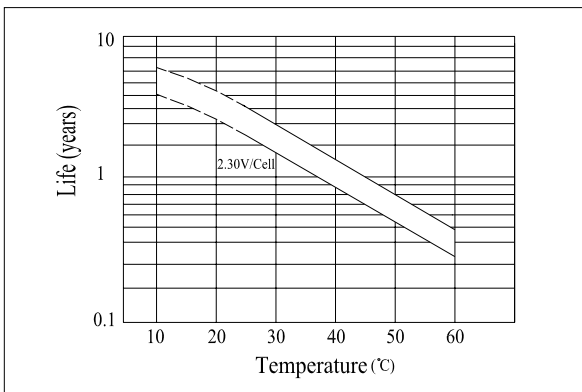

Cycle Life on D.O.D.(25°C)

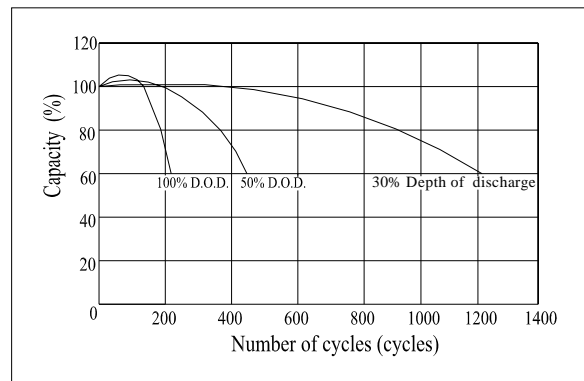

Charging Characteristics(25°C)