

Specifications

Nominal Voltage		12 V
Number of cell		6 cells
Capacity(20HR, 25°C)		20 Ah
Capacity(15min.rate, 25°C)		82 Watts/cell
Dimension	Length	181 ± 2mm (7.13inch)
	Width	77 ± 1mm (3.03inch)
	Height	166 ± 2mm (6.54inch)
	Total Height	166 ± 2mm (6.54inch)
Approx. Weight		6.3kg (13.9lbs) ± 4%
Terminal type		T8
Internal resistance (Fully charged, 25°C)		Approx. 10m Ω
Capacity affected by temperature (20HR)	40°C	102%
	25°C	100%
	0°C	85%
	-15°C	65%
Self-discharge (25°C)	3 month	Remaining Capacity: 91%
	6 month	Remaining Capacity: 82%
	12 month	Remaining Capacity: 65%
Nominal operating temperature		25°C ± 3°C (77°F ± 5°F)
Operating temperature range	Discharge	-15°C ~ 50°C (5°F ~ 122°F)
	Charge	-10°C ~ 50°C (14°F ~ 122°F)
	Storage	-20°C ~ 50°C (-4°F ~ 122°F)
Float charging voltage(25°C)		13.60 to 13.80V Temperature compensation: -18mV/°C
Cyclic charging voltage(25°C)		14.50 to 14.90V Temperature compensation: -30mV/°C
Maximum charging current		6A
Terminal material		Copper
Maximum discharge current		300A(5 sec.)
Designed floating life(20°C)		3~5 years

- ◆ Absorbent glass mat technology;
- ◆ Recognized by UL & CE;
- ◆ ABS container.

Dimensions

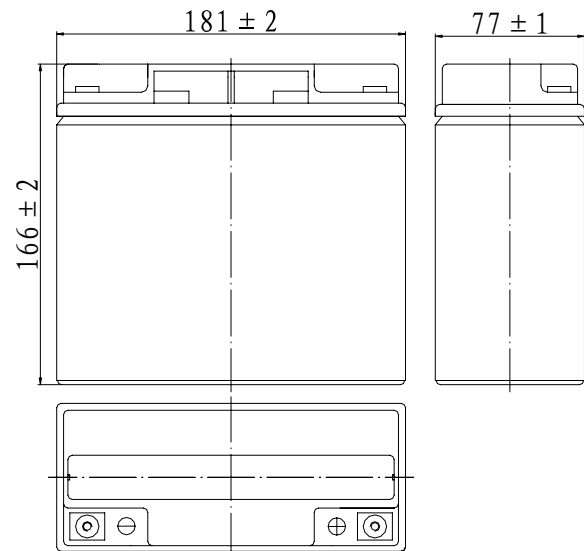

Terminal

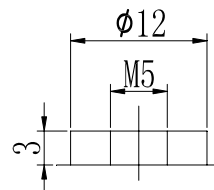

Terminal T8

Constant Current Discharge Characteristics (A, 25°C)

F.V/TIME	10min	15min	20min	30min	45min	60min	2h	3h	5h	10h	20h
1.60V/cell	55.0	43.3	34.4	23.8	17.1	13.5	7.31	5.20	3.57	1.93	1.04
1.65V/cell	53.4	42.3	33.5	23.3	16.7	13.3	7.26	5.17	3.55	1.92	1.03
1.67V/cell	52.6	41.6	33.0	23.0	16.5	13.1	7.24	5.16	3.54	1.92	1.03
1.70V/cell	51.2	40.7	32.3	22.6	16.2	12.9	7.20	5.14	3.52	1.91	1.03
1.75V/cell	49.0	39.4	31.2	22.1	15.8	12.7	7.09	5.10	3.50	1.90	1.02
1.80V/cell	46.2	37.3	29.6	21.3	15.2	12.3	6.91	4.95	3.40	1.86	1.00

Constant Power Discharge Characteristics (Watt/cell, 25°C)

F.V/TIME	10min	15min	20min	30min	45min	60min	2h	3h	5h	10h	20h
1.60V/cell	106	85.4	67.7	46.9	33.6	26.5	14.5	10.4	7.14	3.86	2.07
1.65V/cell	103	83.3	66.1	46.0	33.0	26.1	14.4	10.3	7.10	3.84	2.06
1.67V/cell	101	82.0	65.0	45.4	32.6	25.9	14.3	10.3	7.08	3.83	2.06
1.70V/cell	98.8	80.3	63.6	44.6	31.9	25.5	14.3	10.3	7.05	3.82	2.05
1.75V/cell	94.5	77.5	61.5	43.5	31.2	25.0	14.0	10.2	7.00	3.80	2.04
1.80V/cell	89.2	73.4	58.2	41.9	30.0	24.2	13.7	9.89	6.79	3.72	2.00

Note: The above characteristics data can be obtained within three charge/discharge cycles.

Discharge Characteristics(25°C)

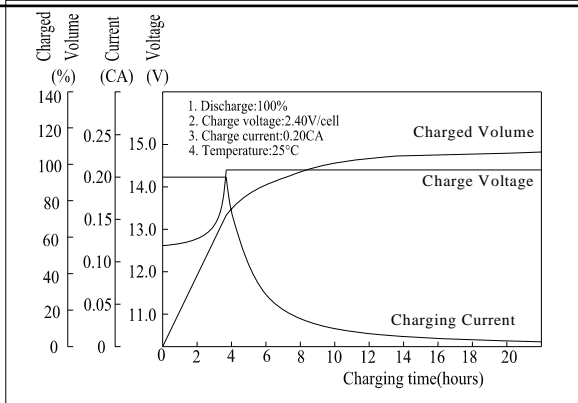
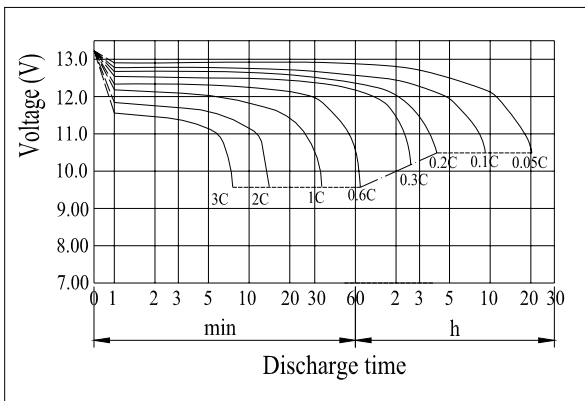

Effect of Temperature on Capacity

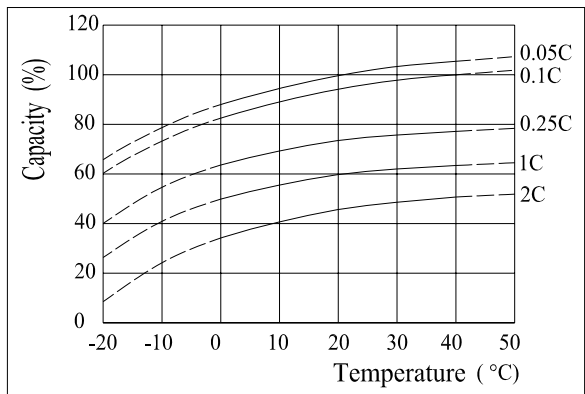

Self-discharge Characteristics

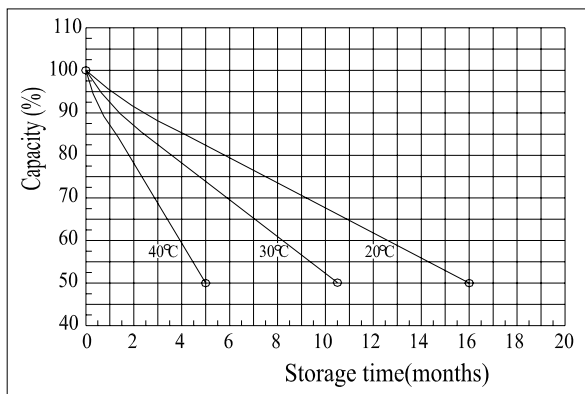

The Relationship for Open Circuit Voltage and Residual Capacity (25°C)

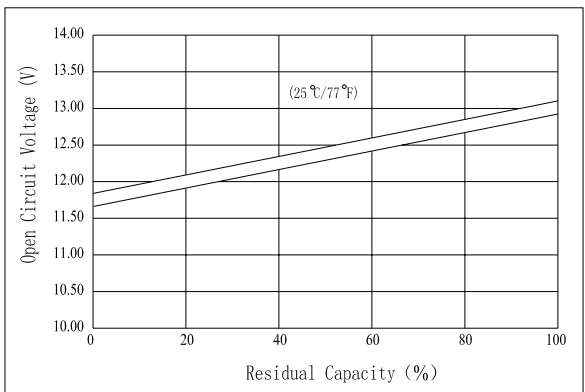

The Relationship for Charging Voltage and Temperature

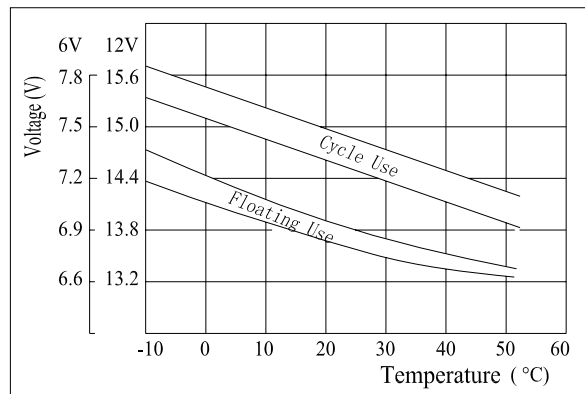

Floating Life on Temperature

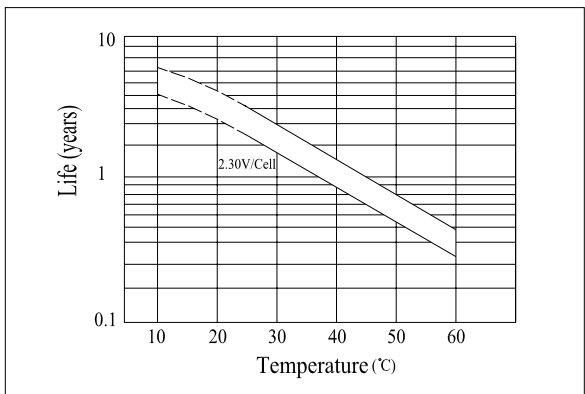

Cycle Life on D.O.D.(25°C)

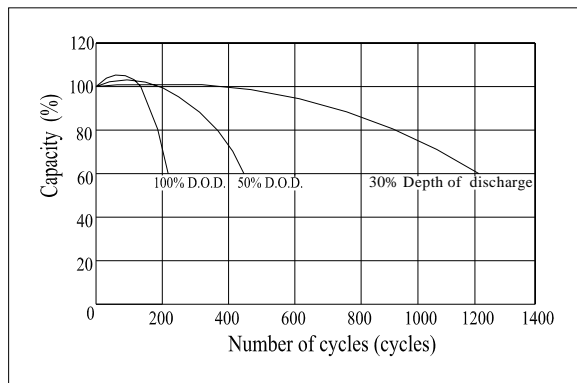

Charging Characteristics(25°C)