

Specifications

Nominal Voltage		12 V
Number of cell		6 cells
Capacity(10HR, 25°C)		45 Ah
Capacity(15min.rate, 25°C)		160 Watts/cell
Dimension	Length	197 ± 2mm (7.76inch)
	Width	165 ± 2mm (6.50inch)
	Height	170 ± 2mm (6.69inch)
	Total Height	170 ± 2mm (6.69inch)
Approx. Weight		14.2kg (31.3lbs) ± 5%
Terminal type		T4/T9
Internal resistance (Fully charged, 25°C)		Approx. 7.5m Ω
Capacity affected by temperature (20HR)	40°C	102%
	25°C	100%
	0°C	85%
	-15°C	65%
Self-discharge (25°C)	3 month	Remaining Capacity: 91%
	6 month	Remaining Capacity: 82%
	12 month	Remaining Capacity: 65%
Nominal operating temperature		25°C ± 3°C (77°F ± 5°F)
Operating temperature range	Discharge	-15°C ~ 50°C (5°F ~ 122°F)
	Charge	-10°C ~ 50°C (14°F ~ 122°F)
	Storage	-20°C ~ 50°C (-4°F ~ 122°F)
Float charging voltage(25°C)		13.50 to 13.80V Temperature compensation: -18mV/°C
Cyclic charging voltage(25°C)		14.50 to 14.90V Temperature compensation: -30mV/°C
Maximum charging current		13.5A
Terminal material		Copper
Maximum discharge current		450A(5 sec.)
Designed floating life(20°C)		7~10 years

- ◆ Absorbent glass mat technology;
- ◆ Recognized by UL & CE;
- ◆ ABS container.

Dimensions

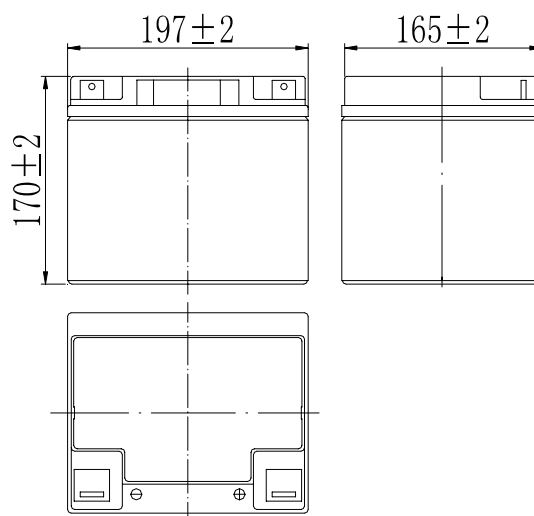

Terminal

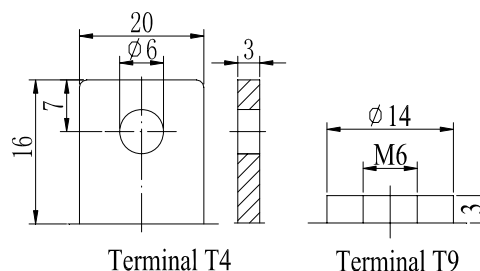

Constant Current Discharge Characteristics (A, 25°C)

F.V/TIME	10min	15min	20min	30min	45min	60min	2h	3h	5h	10h	20h
1.60V/cell	104	85.2	68.2	48.3	36.0	29.4	16.4	11.8	8.26	4.63	2.45
1.65V/cell	101	83.2	66.5	47.3	35.3	28.9	16.3	11.7	8.21	4.62	2.45
1.67V/cell	99.5	82.7	65.4	46.7	34.8	28.6	16.3	11.7	8.19	4.61	2.44
1.70V/cell	96.9	80.1	64.1	45.9	34.2	28.2	16.2	11.6	8.16	4.60	2.44
1.75V/cell	92.7	77.4	61.9	44.8	33.4	27.6	16.0	11.6	8.10	4.58	2.42
1.80V/cell	87.5	73.3	58.6	43.1	32.1	26.8	15.6	11.2	7.86	4.55	2.41

Constant Power Discharge Characteristics (Watt/cell, 25°C)

F.V/TIME	10min	15min	20min	30min	45min	60min	2h	3h	5h	10h	20h
1.60V/cell	196	164	132	93.2	69.4	56.6	32.1	23.2	16.4	9.25	4.90
1.65V/cell	190	161	128	91.3	68.0	55.8	31.9	23.1	16.3	9.24	4.89
1.67V/cell	187	160	126	90.2	67.2	55.2	31.8	23.0	16.2	9.23	4.89
1.70V/cell	182	155	124	88.5	66.0	54.4	31.6	22.9	16.2	9.21	4.88
1.75V/cell	174	149	119	86.4	64.4	53.3	31.1	22.8	16.0	9.15	4.85
1.80V/cell	164	141	113	83.2	62.0	51.7	30.3	22.1	15.6	9.09	4.82

Note: The above characteristics data can be obtained within three charge/discharge cycles.

Discharge Characteristics(25°C)

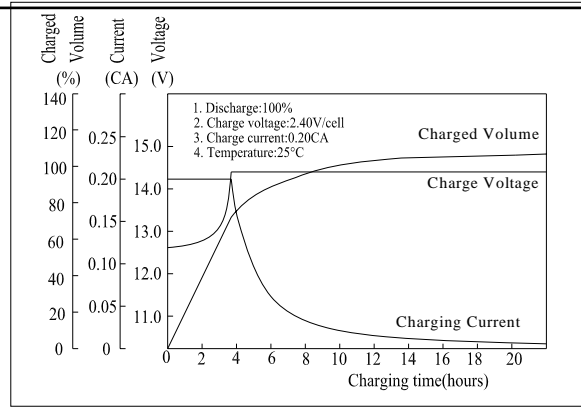
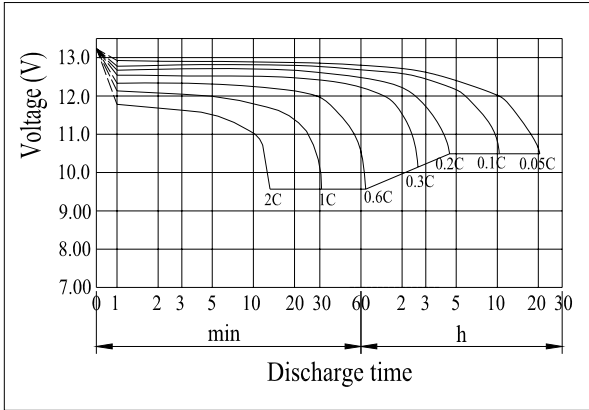

Effect of Temperature on Capacity

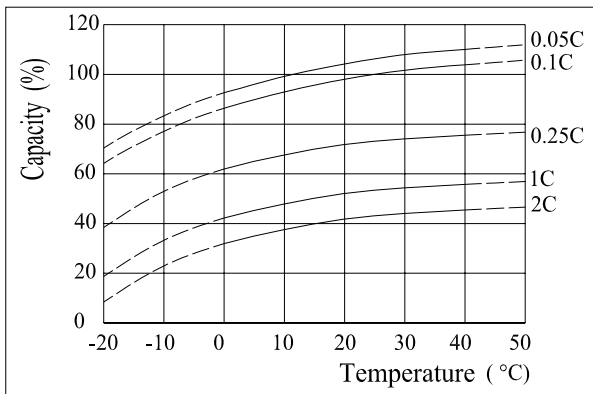

Self-discharge Characteristics

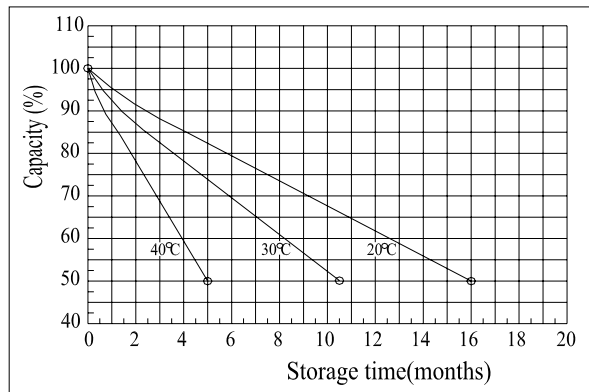

The Relationship for Open Circuit Voltage and Residual Capacity (25°C)

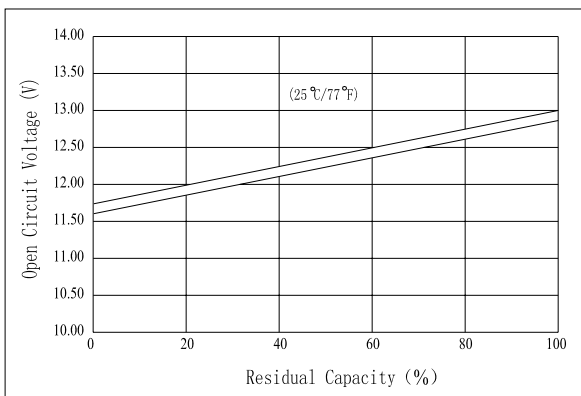

The Relationship for Charging Voltage and Temperature

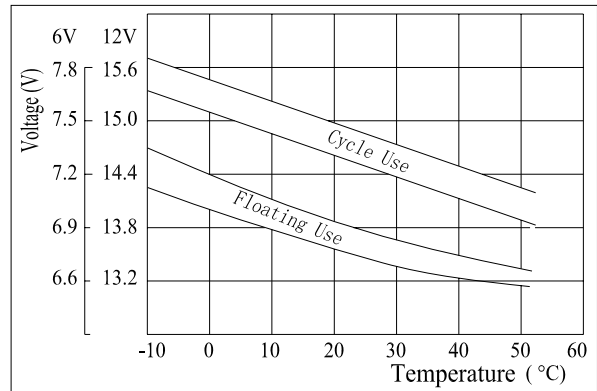

Floating Life on Temperature

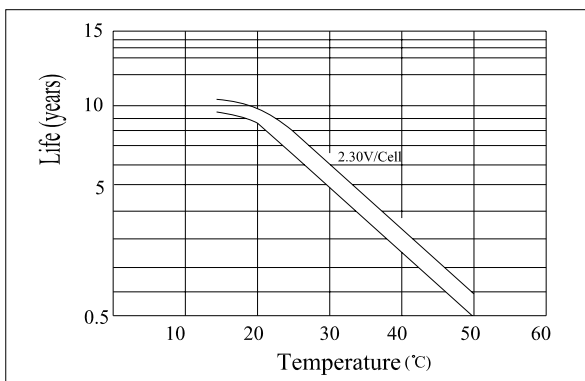

Cycle Life on D.O.D.(25°C)

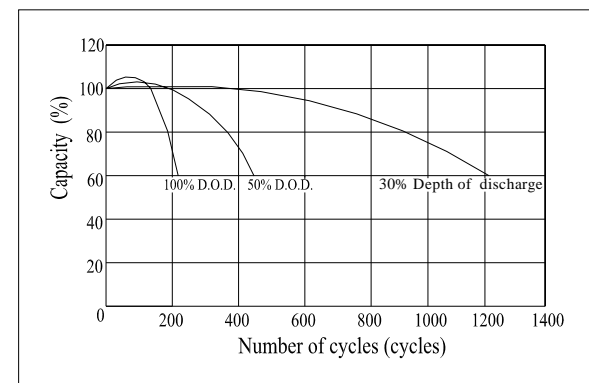

Charging Characteristics(25°C)