

**Specifications**

Nominal Voltage		12 V
Number of cell		6 cells
Capacity(10HR, 25°C)		90 Ah
Capacity(15min.rate, 25°C)		320 Watts/cell
Dimension	Length	306mm ± 2 (12.05inch)
	Width	169mm ± 2 (6.65inch)
	Height	211mm ± 2 (8.31inch)
	Total Height	T5: 233 ± 2mm (9.17inch) T9: 214 ± 2mm (8.43inch)
Approx. Weight		29.5kg (65.0lbs) ± 5%
Terminal type		T5/T9
Internal resistance (Fully charged, 25°C)		Approx. 4.5m Ω
Capacity affected by temperature (20HR)	40°C	102%
	25°C	100%
	0°C	85%
	-15°C	65%
Self-discharge (25°C)	3 month	Remaining Capacity: 91%
	6 month	Remaining Capacity: 82%
	12 month	Remaining Capacity: 65%
Nominal operating temperature		25°C ± 3°C (77°F ± 5°F)
Operating temperature range	Discharge	-15°C ~ 50°C (5°F ~ 122°F)
	Charge	-10°C ~ 50°C (14°F ~ 122°F)
	Storage	-20°C ~ 50°C (-4°F ~ 122°F)
Float charging voltage(25°C)		13.50 to 13.80V Temperature compensation: -18mV/°C
Cyclic charging voltage(25°C)		14.50 to 14.90V Temperature compensation: -30mV/°C
Maximum charging current		27A
Terminal material		Copper
Maximum discharge current		800A(5 sec.)
Designed floating life(20°C)		7~10 years

- ◆ Absorbent glass mat technology;
- ◆ Recognized by UL & CE;
- ◆ ABS container.

**Constant Current Discharge Characteristics (A, 25°C)**

F.V/TIME	10min	15min	20min	30min	45min	60min	2h	3h	5h	10h	20h
1.60V/cell	209	171	137	96.8	72.2	58.9	32.9	23.6	16.5	9.25	4.90
1.65V/cell	203	167	133	94.9	70.7	58.0	32.7	23.5	16.4	9.24	4.89
1.67V/cell	199	166	131	93.7	69.9	57.4	32.6	23.4	16.4	9.23	4.89
1.70V/cell	194	161	129	92.0	68.6	56.5	32.4	23.3	16.3	9.21	4.88
1.75V/cell	186	155	124	89.8	66.9	55.4	31.9	23.1	16.2	9.15	4.85
1.80V/cell	175	147	118	86.5	64.4	53.7	31.1	22.4	15.7	9.09	4.82

**Constant Power Discharge Characteristics (Watt/cell, 25°C)**

F.V/TIME	10min	15min	20min	30min	45min	60min	2h	3h	5h	10h	20h
1.60V/cell	393	330	264	187	139	114	64.1	46.5	32.7	18.5	9.80
1.65V/cell	381	322	258	183	136	112	63.7	46.2	32.5	18.5	9.78
1.67V/cell	375	320	253	181	135	111	63.6	46.1	32.4	18.5	9.77
1.70V/cell	365	310	248	178	132	109	63.2	45.9	32.3	18.4	9.76
1.75V/cell	350	300	240	173	129	107	62.2	45.6	32.1	18.3	9.70
1.80V/cell	330	284	227	167	124	104	60.7	44.2	31.1	18.2	9.63

Note: The above characteristics data can be obtained within three charge/discharge cycles.

**Dimensions**

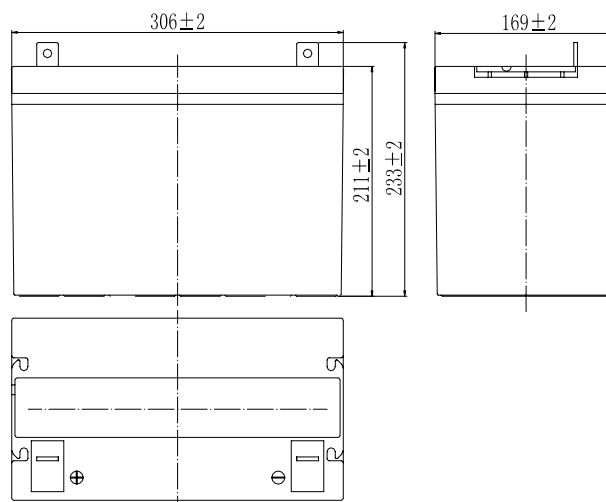

**Terminal**

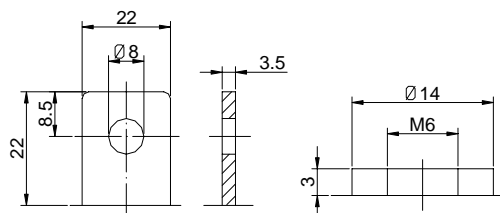

Terminal T5

Terminal T9

**Discharge Characteristics(25°C)**

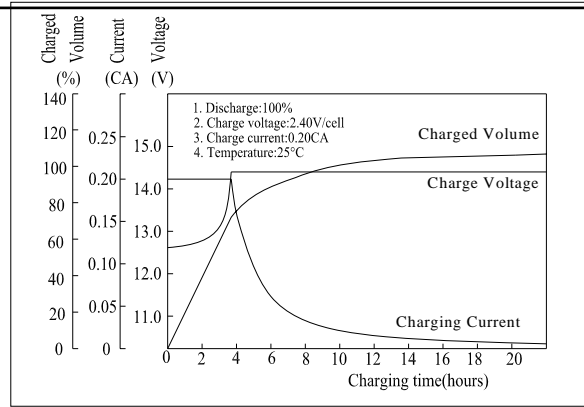
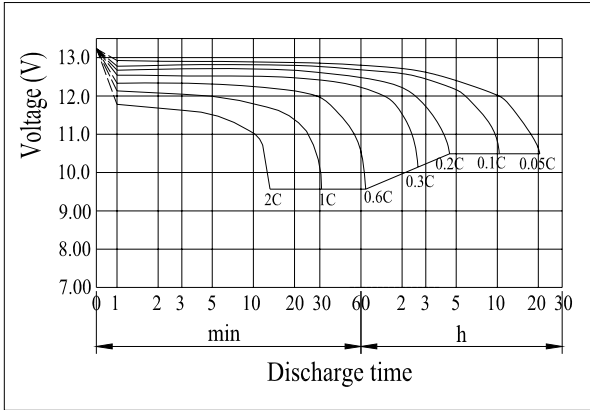

**Self-discharge Characteristics**

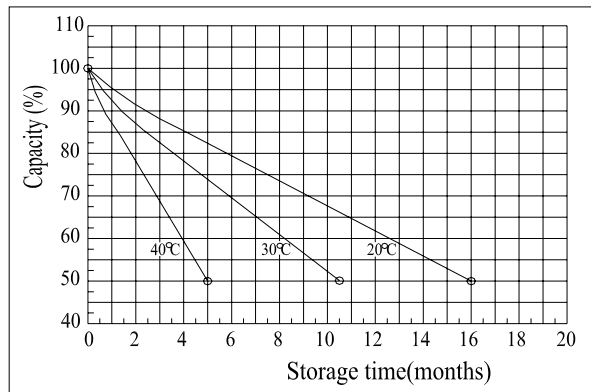

**Effect of Temperature on Capacity**

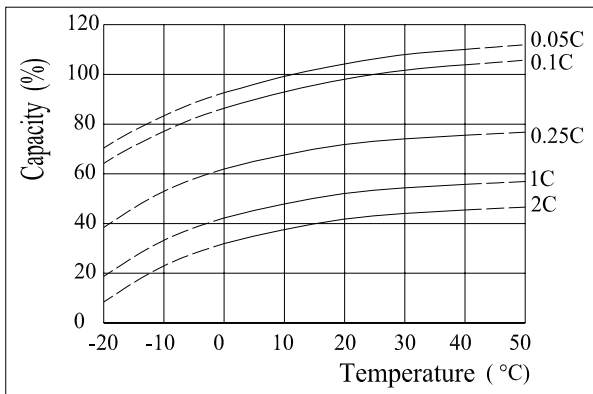

**The Relationship for Charging Voltage and Temperature**

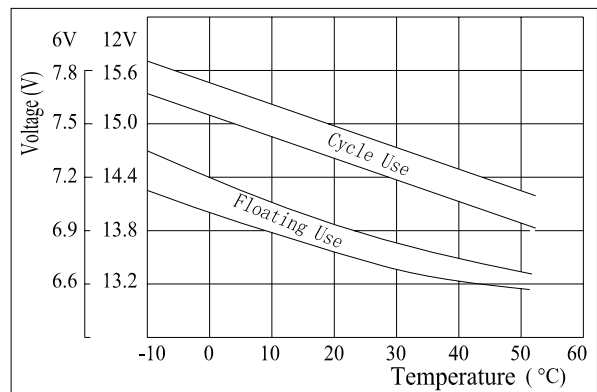

**The Relationship for Open Circuit Voltage and Residual Capacity (25°C)**

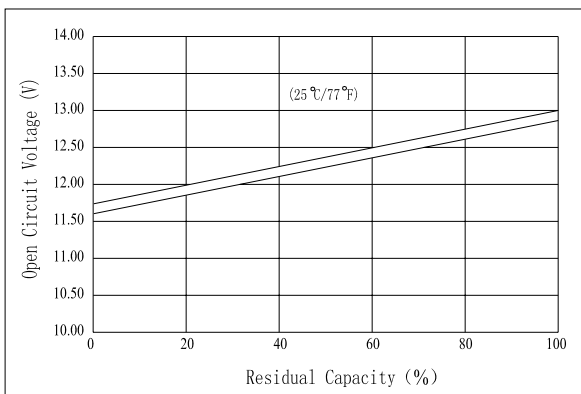

**Cycle Life on D.O.D(25°C)**

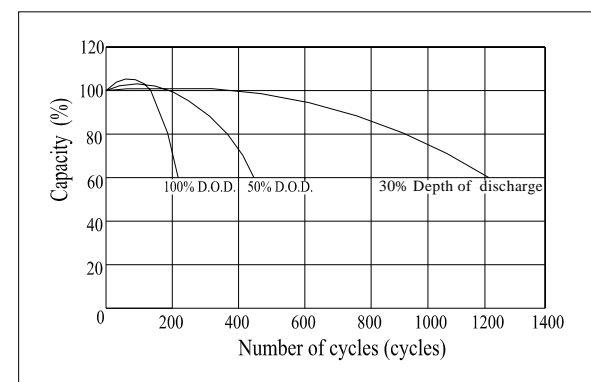

**Floating Life on Temperature**

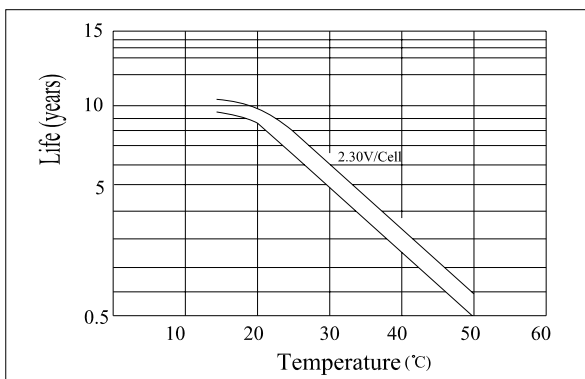

**Charging Characteristics(25°C)**