

## LFP12100NHR FR(12V, 2800Watts/cell@10min.Rate)

### Specifications

Nominal Voltage		12 V
Number of cell		6 cells
Capacity(10min.rate, 25°C)		2800 Watts@1.75V/cell
Dimension	Length	330±2mm (12.99inch)
	Width	171±2mm (6.73inch)
	Height	214±2mm (8.43inch)
	Total Height	T5: 224±2mm (8.82inch) T9: 220±2mm (8.66inch)
Approx. Weight		32.0kg (70.4lbs)±5%
Terminal type		T5/T9
Internal resistance (Fully charged, 25°C)		Approx. 4.0mΩ
Capacity affected by temperature (20HR)	40°C	102%
	25°C	100%
	0°C	85%
	-15°C	65%
Self-discharge (25°C)	3 month	Remaining Capacity: 91%
	6 month	Remaining Capacity: 82%
	12 month	Remaining Capacity: 65%
Nominal operating temperature		25°C±3°C(77°F±5°F)
Operating temperature range	Discharge	-40°C~50°C(-40°F~122°F)
	Charge	-10°C~45°C(14°F~113°F)
	Storage	-20°C~50°C(-4°F~122°F)
Float charging voltage(25°C)		13.50 to 13.80V Temperature compensation: -18mV/°C
Cyclic charging voltage(25°C)		14.50 to 14.90V Temperature compensation: -30mV/°C
Maximum charging current		30A
Terminal material		Copper
Maximum discharge current		800A(5 sec.)
Designed floating life(25°C)		10 years

- ◆ Specially designed for high power output.
- ◆ Absorbent glass mat technology;
- ◆ Recognized by UL & CE;
- ◆ UL94-VO ABS container.

### Dimensions

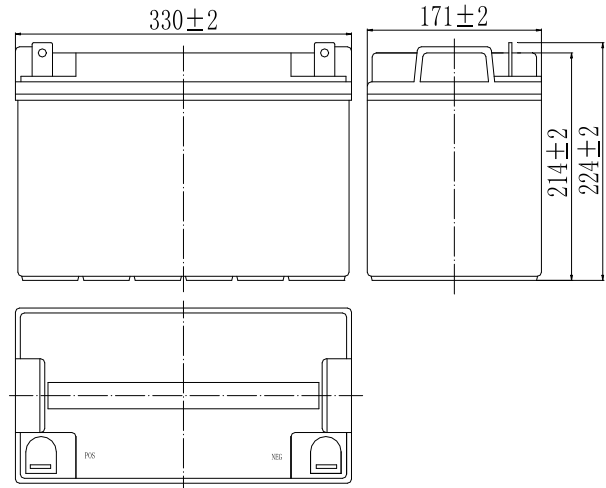

### Terminal

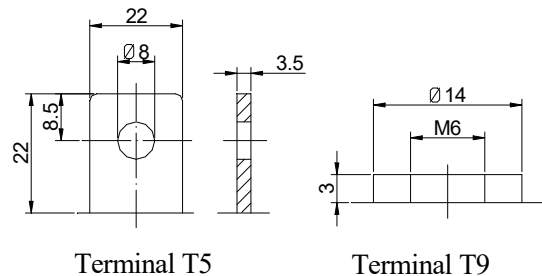

### Constant Current Discharge Characteristics (A, 25°C)

F. V/TIME	5min	10min	15min	20min	30min	45min	60min	2h	3h	5h	10h
1.60V/cell	392	265	214	172	121	90.4	73.8	38.4	27.6	19.4	10.2
1.65V/cell	381	254	209	167	119	88.6	72.6	38.2	27.5	19.3	10.2
1.67V/cell	375	247	207	164	118	87.5	71.9	38.1	27.4	19.2	10.2
1.70V/cell	364	242	201	161	115	85.9	70.8	37.9	27.3	19.1	10.0
1.75V/cell	350	236	195	156	113	83.8	69.4	37.4	27.1	18.9	10.0
1.80V/cell	329	220	184	147	108	80.7	67.3	36.4	26.2	18.4	10.0

### Constant Power Discharge Characteristics (Watt/cell, 25°C)

F. V/TIME	5min	10min	15min	20min	30min	45min	60min	2h	3h	5h	10h
1.60V/cell	722	512	414	331	234	175	142	75.1	54.3	38.3	20.4
1.65V/cell	692	500	403	323	229	171	140	74.5	54.0	38.0	20.3
1.67V/cell	681	485	401	317	226	168	139	74.3	53.8	37.9	20.3
1.70V/cell	663	474	388	311	222	165	137	73.9	53.5	37.7	20.1
1.75V/cell	635	468	375	300	217	162	134	72.7	53.3	37.5	20.1
1.80V/cell	602	434	356	284	209	156	129	70.9	51.7	36.4	20.0

Note: The above characteristics data can be obtained within three charge/discharge cycles.

**Discharge Characteristics(25°C)**

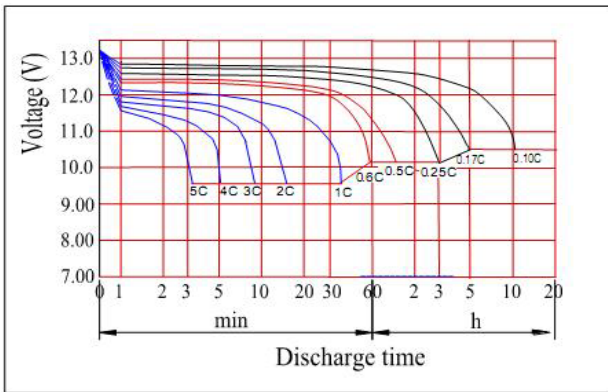

**Charging Characteristics(25°C)**

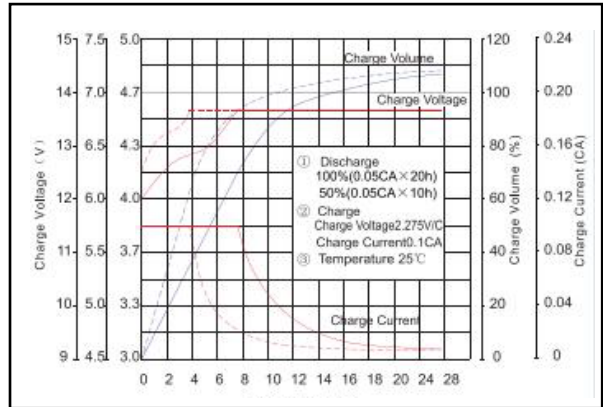

**Effect of Temperature on Capacity**

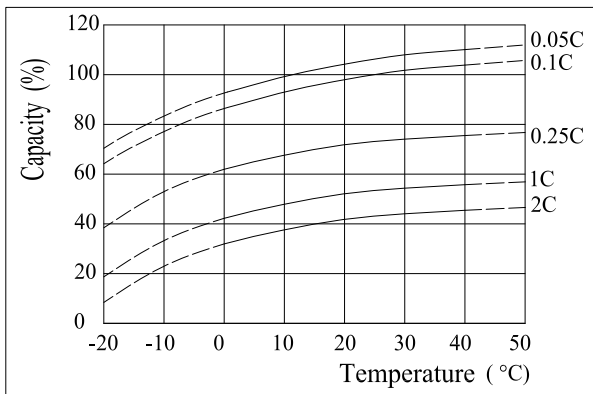

**Self-discharge Characteristics**

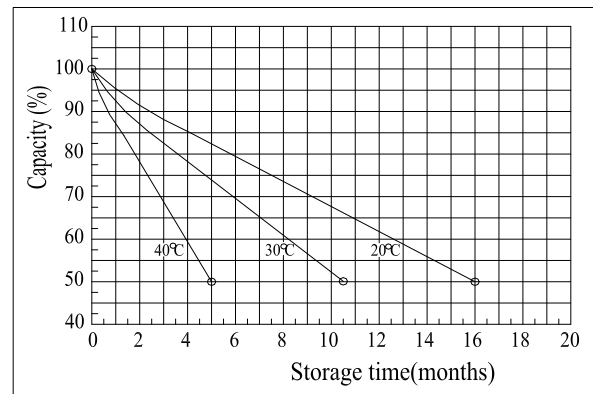

**The Relationship for Open Circuit Voltage and Residual Capacity (25°C)**

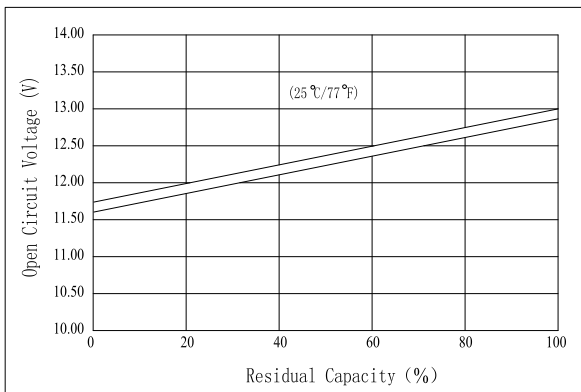

**The Relationship for Charging Voltage and Temperature**

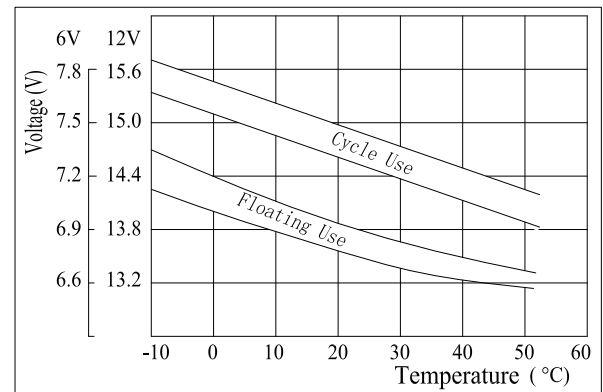

**Floating Life on Temperature**

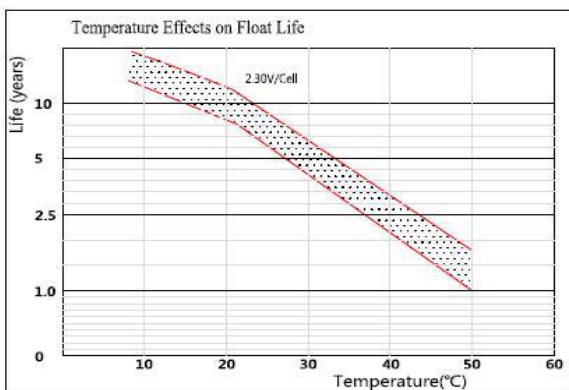

**Cycle Life on D.O.D.(25°C)**

