

Specifications

Nominal Voltage		12 V
Number of cell		6 cells
Capacity(10HR, 25°C)		150 Ah
Capacity(15min.rate, 25°C)		535 Watts/cell
Dimension	Length	485 ± 2mm (19.09inch)
	Width	172 ± 2mm (6.77inch)
	Height	240 ± 2mm (9.45inch)
	Total Height	T5: 242 ± 2mm (9.53inch) T11: 240 ± 2mm (9.45inch)
Approx. Weight		47kg (103.6lbs) ± 5%
Terminal type		T5/T9
Internal resistance (Fully charged, 25°C)		Approx. 3.0m Ω
Capacity affected by temperature (20HR)	40°C	102%
	25°C	100%
	0°C	85%
	-15°C	65%
Self-discharge (25°C)	3 month	Remaining Capacity: 91%
	6 month	Remaining Capacity: 82%
	12 month	Remaining Capacity: 65%
Nominal operating temperature		25°C ± 3°C (77°F ± 5°F)
Operating temperature range	Discharge	-15°C ~ 50°C (5°F ~ 122°F)
	Charge	-10°C ~ 50°C (14°F ~ 122°F)
	Storage	-20°C ~ 50°C (-4°F ~ 122°F)
Float charging voltage(25°C)		13.50 to 13.80V Temperature compensation: -18mV/°C
Cyclic charging voltage(25°C)		14.50 to 14.90V Temperature compensation: -30mV/°C
Maximum charging current		45A
Terminal material		Copper
Maximum discharge current		1200A(5 sec.)
Designed floating life(20°C)		7~10 years

- ◆ Absorbent glass mat technology;
- ◆ Recognized by UL & CE;
- ◆ ABS container.

Constant Current Discharge Characteristics (A, 25°C)

F.V/TIME	15min	20min	30min	45min	60min	2h	3h	4h	5h	10h	20h
1.60V/cell	286	229	162	121	98.4	54.8	39.3	31.7	27.5	15.4	8.17
1.65V/cell	279	223	159	118	96.9	54.5	39.1	31.5	27.4	15.4	8.15
1.67V/cell	277	219	157	117	95.9	54.3	39.0	31.4	27.3	15.4	8.15
1.70V/cell	269	215	154	115	94.5	54.0	38.8	31.3	27.2	15.3	8.13
1.75V/cell	259	208	150	112	92.6	53.2	38.6	31.1	27.0	15.3	8.08
1.80V/cell	246	197	145	108	89.7	51.8	37.4	30.1	26.2	15.2	8.03

Constant Power Discharge Characteristics (Watt/cell, 25°C)

F.V/TIME	15min	20min	30min	45min	60min	2h	3h	4h	5h	10h	20h
1.60V/cell	551	441	312	233	190	107	77.5	62.4	54.5	30.8	16.3
1.65V/cell	538	430	306	228	187	106	77.0	62.0	54.2	30.8	16.3
1.67V/cell	535	423	302	225	185	106	76.8	61.8	54.0	30.8	16.3
1.70V/cell	518	415	297	221	182	105	76.5	61.6	53.8	30.7	16.3
1.75V/cell	501	400	290	216	179	104	75.9	61.2	53.5	30.5	16.2
1.80V/cell	474	379	279	208	173	101	73.7	59.3	51.9	30.3	16.1

Note: The above characteristics data can be obtained within three charge/discharge cycles.

Dimensions

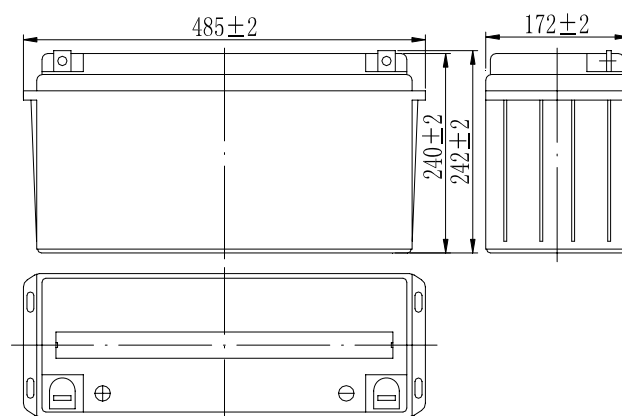

Terminal

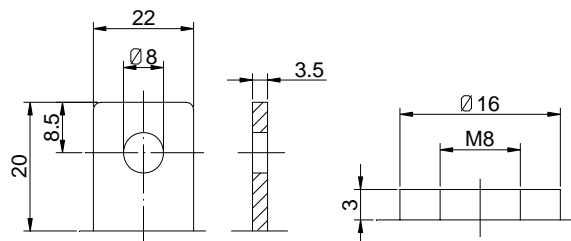

Terminal T5

Terminal T11

Discharge Characteristics(25°C)

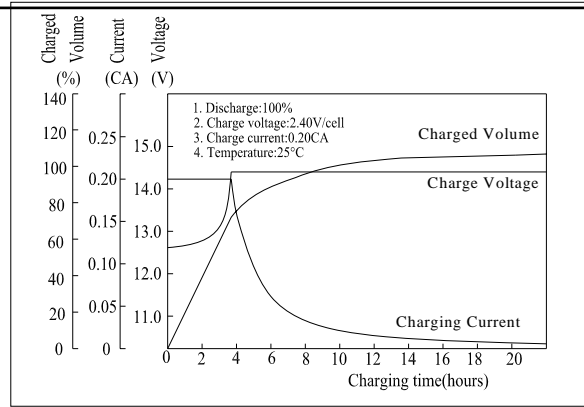
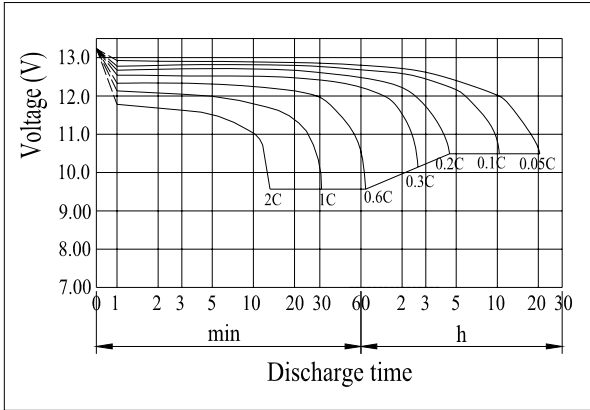

Self-discharge Characteristics

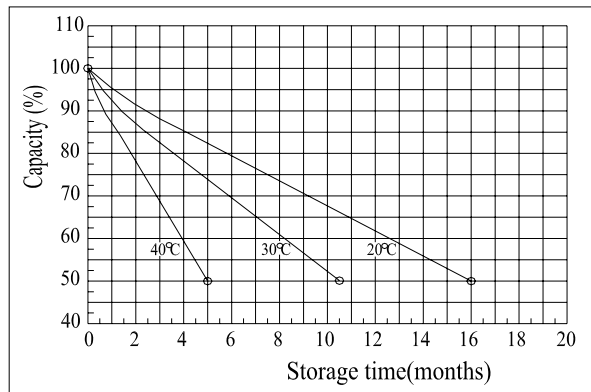

Effect of Temperature on Capacity

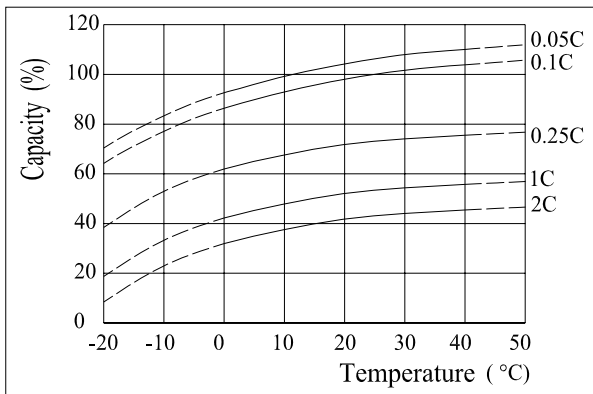

The Relationship for Charging Voltage and Temperature

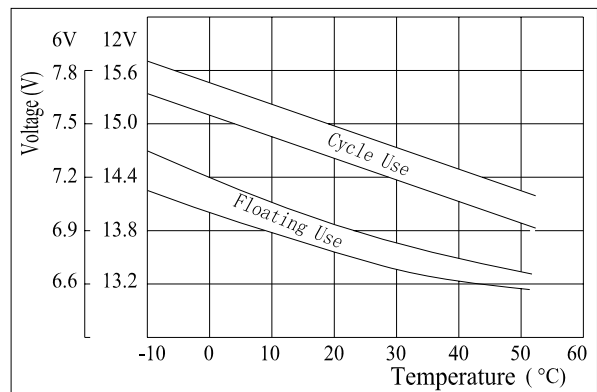

The Relationship for Open Circuit Voltage and Residual Capacity (25°C)

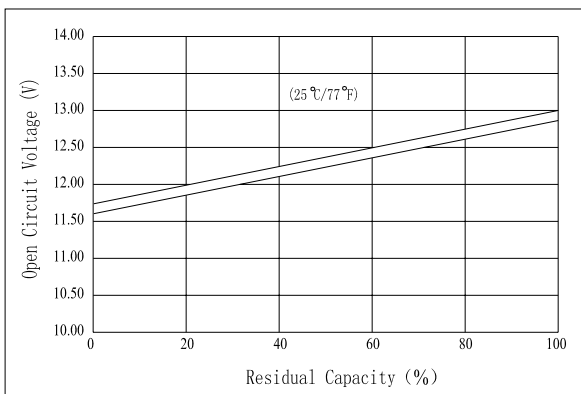

Cycle Life on D.O.D.(25°C)

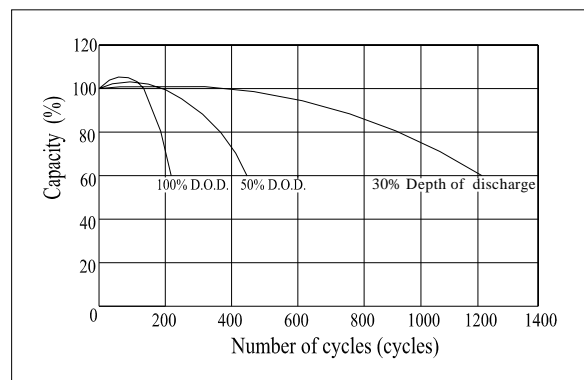

Floating Life on Temperature

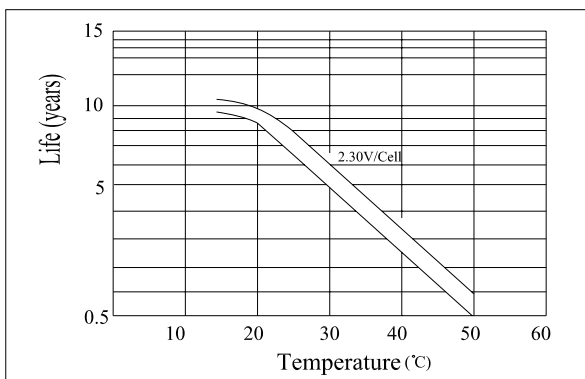

Charging Characteristics(25°C)