

Specifications

Nominal Voltage		12 V
Number of cell		6 cells
Capacity(10HR, 25°C)		200 Ah
Capacity(15min.rate, 25°C)		710 Watts/cell
Dimension	Length	522±2mm (20.55inch)
	Width	238±2mm (9.37inch)
	Height	218±2mm (8.58inch)
	Total Height	T5: 238±2mm (9.37inch) T11: 221±2mm (8.70inch)
Approx. Weight		65kg (143.3lbs)±3%
Terminal type		T5/T9
Internal resistance (Fully charged, 25°C)		Approx. 2.8m Ω
Capacity affected by temperature (20HR)	40°C	102%
	25°C	100%
	0°C	85%
	-15°C	65%
Self-discharge (25°C)	3 month	Remaining Capacity: 91%
	6 month	Remaining Capacity: 82%
	12 month	Remaining Capacity: 65%
Nominal operating temperature		25°C ± 3°C (77°F ± 5°F)
Operating temperature range	Discharge	-15°C ~ 50°C (5°F ~ 122°F)
	Charge	-10°C ~ 50°C (14°F ~ 122°F)
	Storage	-20°C ~ 50°C (-4°F ~ 122°F)
Float charging voltage(25°C)		13.50 to 13.80V Temperature compensation: -18mV/°C
Cyclic charging voltage(25°C)		14.50 to 14.90V Temperature compensation: -30mV/°C
Maximum charging current		60A
Terminal material		Copper
Maximum discharge current		1600A(5 sec.)
Designed floating life(20°C)		7~10 years

- ◆ Absorbent glass mat technology;
- ◆ Recognized by UL & CE;
- ◆ ABS container.

Dimensions

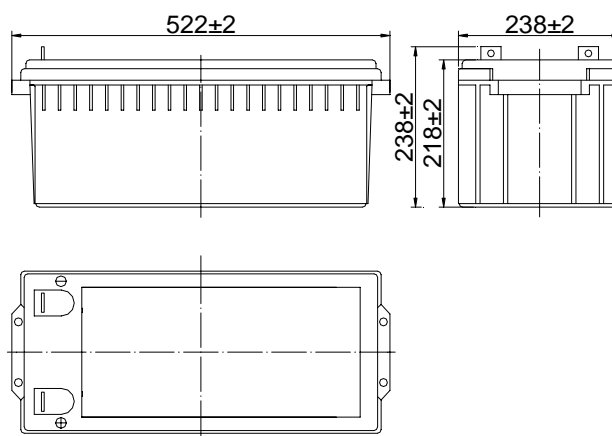

Terminal

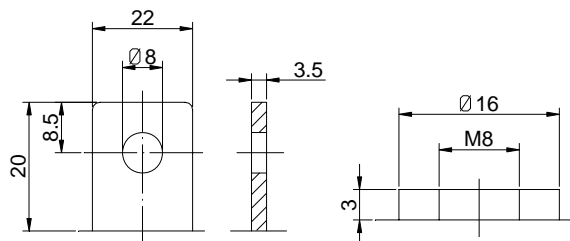

Terminal T5

Terminal T11

Constant Current Discharge Characteristics (A, 25°C)

F.V/TIME	15min	20min	30min	45min	60min	2h	3h	4h	5h	10h	20h
1.60V/cell	379	304	215	160	131	73.1	52.4	42.2	36.7	20.6	10.9
1.65V/cell	370	296	211	157	129	72.6	52.1	42.0	36.5	20.5	10.9
1.67V/cell	368	291	208	155	127	72.4	52.0	41.9	36.4	20.5	10.9
1.70V/cell	357	285	204	152	125	72.0	51.8	41.7	36.3	20.5	10.8
1.75V/cell	345	276	199	149	123	70.9	51.4	41.4	36.0	20.3	10.8
1.80V/cell	326	261	192	143	119	69.1	49.9	40.2	34.9	20.2	10.7

Constant Power Discharge Characteristics (Watt/cell, 25°C)

F.V/TIME	15min	20min	30min	45min	60min	2h	3h	4h	5h	10h	20h
1.60V/cell	732	586	415	309	252	143	103	83.2	72.7	41.1	21.8
1.65V/cell	715	572	407	303	248	142	103	82.7	72.3	41.0	21.7
1.67V/cell	710	562	402	299	246	141	102	82.5	72.1	41.0	21.7
1.70V/cell	688	551	394	294	242	140	102	82.1	71.8	40.9	21.7
1.75V/cell	665	532	385	287	237	138	101	81.6	71.3	40.7	21.5
1.80V/cell	630	504	371	276	230	135	98.2	79.1	69.1	40.4	21.4

Note: The above characteristics data can be obtained within three charge/discharge cycles.

Discharge Characteristics(25°C)

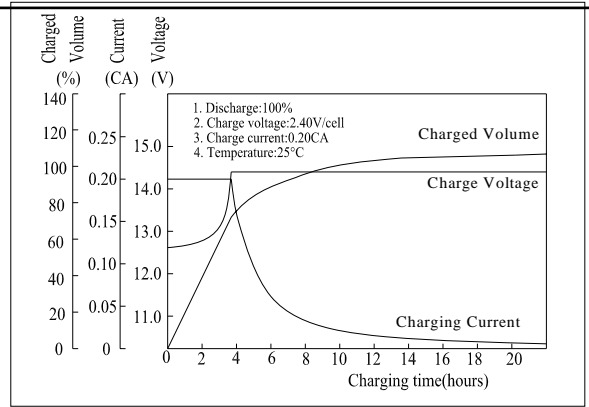
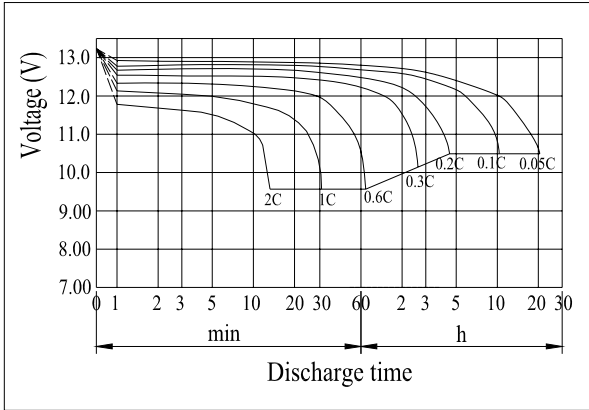

Effect of Temperature on Capacity

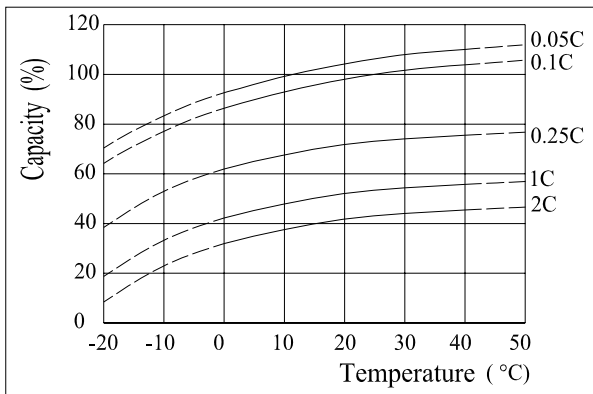

Self-discharge Characteristics

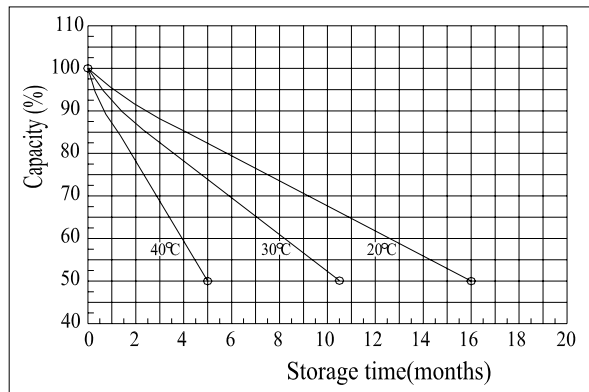

The Relationship for Open Circuit Voltage and Residual Capacity (25°C)

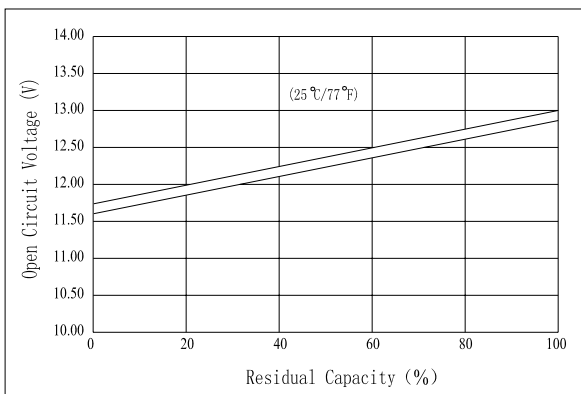

The Relationship for Charging Voltage and Temperature

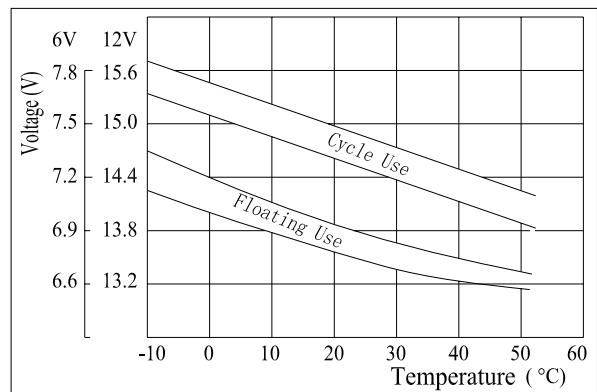

Floating Life on Temperature

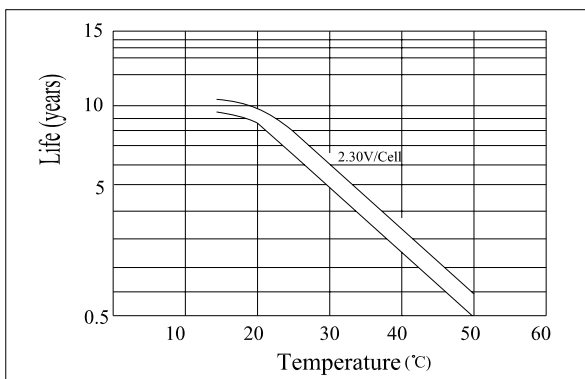

Cycle Life on D.O.D(25°C)

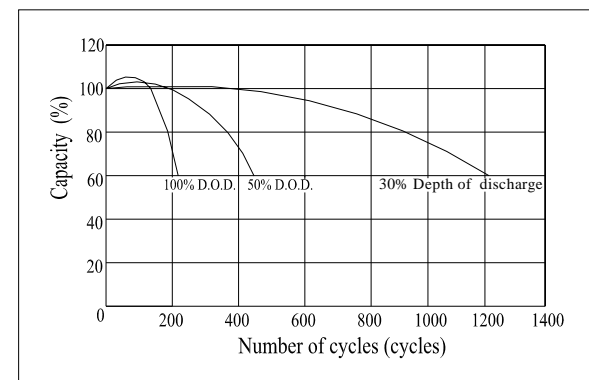

Charging Characteristics(25°C)