

Specifications

Nominal Voltage		2 V
Capacity (25°C)	120HR(1.80V)	366Ah
	10HR(1.80V)	300 Ah
	1HR(1.60V)	168Ah
Dimension	Length	145 ± 2mm (5.71inch)
	Width	206 ± 2mm (8.11inch)
	Height	355 ± 3mm (13.9inch)
	Total Height	390 ± 3mm (15.3inch)
Approx. Weight		23.5kg (51.7lbs) ± 4%
Terminal type		T10
Internal resistance (Fully charged, 25°C)		Approx.0.90 m Ω
Capacity affected by temperature (10HR)	40°C	103%
	25°C	100%
	0°C	88%
	-15°C	70%
Self-discharge (25°C)	3 month	Remaining Capacity: 94%
	6 month	Remaining Capacity: 88%
	12 month	Remaining Capacity: 75%
Nominal operating temperature		25°C ± 3°C (77°F ± 5°F)
Operating temperature range	Discharge	-15°C ~ 50°C (5°F ~ 122°F)
	Charge	-10°C ~ 50°C (14°F ~ 122°F)
	Storage	-20°C ~ 50°C (-4°F ~ 122°F)
Float charging voltage(25°C)		2.25 to 2.27V Temperature compensation: -3mV/°C
Cyclic charging voltage(25°C)		2.35 to 2.40V Temperature compensation: -4mV/°C
Maximum charging current		60A
Terminal material		Copper
Maximum discharge current		1500A(5 sec.)
Designed floating life(20°C)		20 years

- ◆ Gelled electrolyte technology;
- ◆ Tubular Positive Plate;
- ◆ ABS container.
- ◆ DIN 40742 Standard.

Constant Current Discharge Characteristics (A, 25°C)

F.V/TIME	30min	60min	2h	3h	4h	5h	6h	8h	10h	20h	24h	48h	72h	100h	120h
1.65V	250	168	103	79.2	63.9	54.6	46.8	36.9	30.6	16.1	13.9	---	---	---	---
1.70V	242	164	102	78.6	63.3	54.0	46.5	36.6	30.3	16.1	13.8	7.35	---	---	---
1.75V	236	161	101	78.0	63.0	53.7	46.2	36.3	30.3	16.0	13.8	7.32	4.98	---	---
1.80V	228	156	97.8	75.6	61.2	52.2	44.7	35.1	30.0	15.9	13.7	7.26	4.95	---	---
1.85V	216	148	93.0	71.7	58.2	49.5	42.6	33.3	28.5	15.1	13.1	7.11	4.86	3.63	3.05

Constant Power Discharge Characteristics (Watt, 25°C)

F.V/TIME	30min	60min	2h	3h	4h	5h	6h	8h	10h	20h	24h	48h	72h	100h	120h
1.65V	467	320	199	155	125	107	92.4	72.9	60.6	32.4	28.0	---	---	---	---
1.70V	453	312	197	154	124	107	91.8	72.3	60.6	32.1	27.8	14.9	---	---	---
1.75V	442	306	194	153	124	106	90.9	72.0	60.0	32.1	27.7	14.8	10.2	---	---
1.80V	426	296	189	148	120	103	88.2	69.6	59.7	31.8	27.6	14.7	10.1	---	---
1.85V	404	282	180	141	114	97.5	83.7	66.0	56.7	30.2	26.3	14.4	9.90	7.32	6.24

Note: The above characteristics data can be obtained within three charge/discharge cycles.

Dimensions

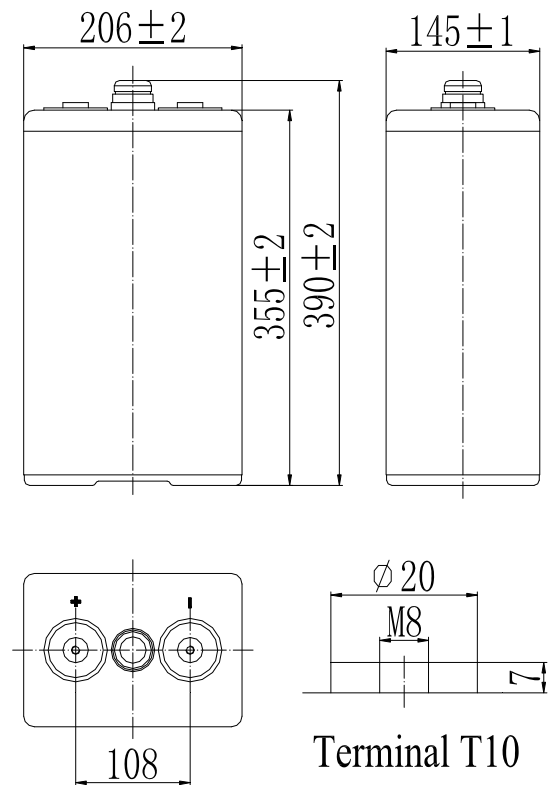

Discharge Characteristics(25°C)

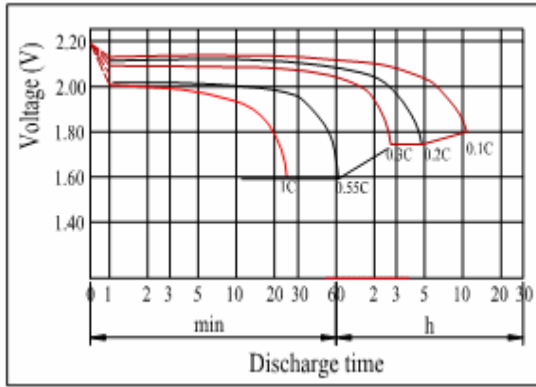

Charging Characteristics(25°C)

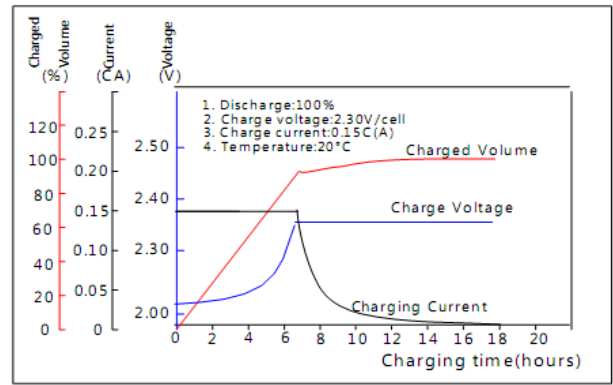

Effect of Temperature on Capacity

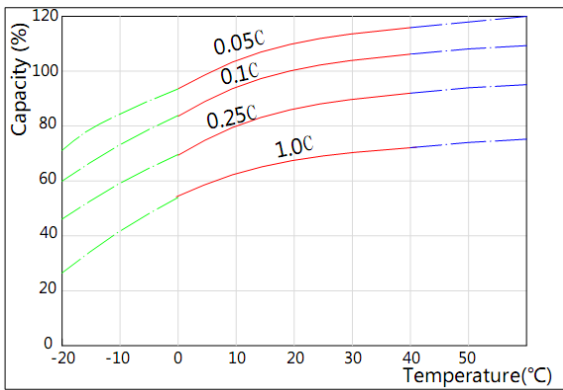

Self-discharge Characteristics

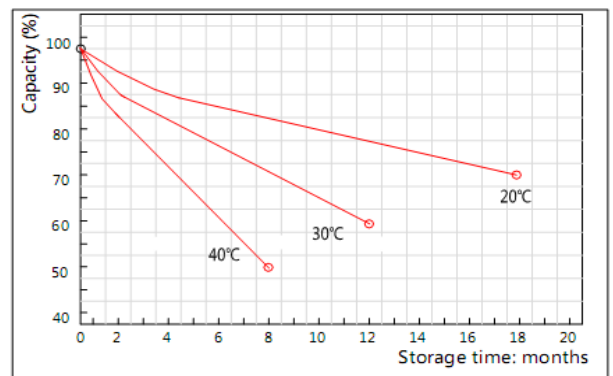

The Relationship for Open Circuit Voltage and Residual Capacity (25°C)

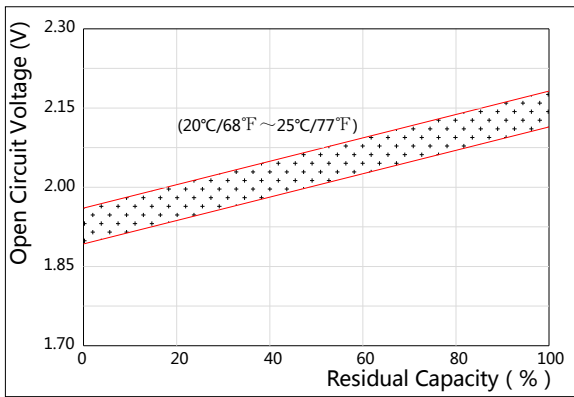

The Relationship for Charging Voltage and Temperature

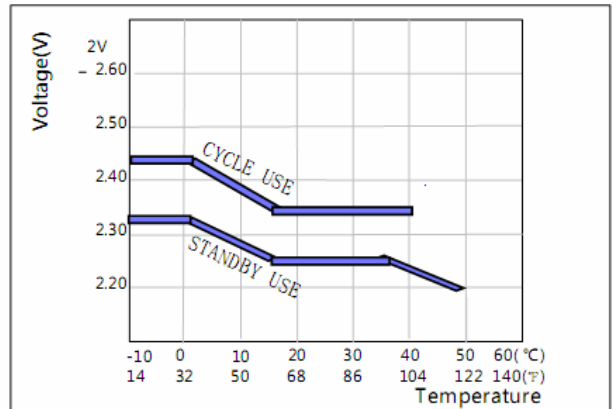

Floating Life on Temperature

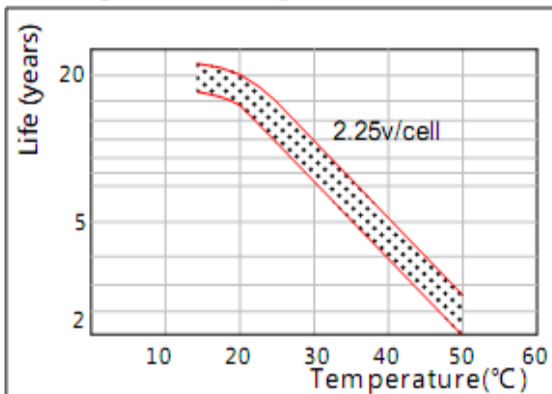

Cycle Life on D.O.D(25°C)

