

## Specifications

Nominal Voltage		12 V
Capacity (25°C)	20HR(10.5V)	24Ah
	5HR(10.2V)	18.7Ah
	1HR(9.6V)	14.0 Ah
Dimension	Length	166 ± 2mm (6.54inch)
	Width	175 ± 2mm (6.89inch)
	Height	125 ± 2mm (4.92inch)
	Total Height	125 ± 2mm (4.92inch)
Approx. Weight		7.4kg (16.3lbs) ± 4%
Terminal type		T8
Internal resistance (Fully charged, 25°C)		Approx. 20m Ω
Capacity affected by temperature (10HR)	40°C	103%
	25°C	100%
	0°C	88%
	-15°C	70%
Self-discharge (25°C)	3 month	Remaining Capacity: 94%
	6 month	Remaining Capacity: 88%
	12 month	Remaining Capacity: 75%
Nominal operating temperature		25°C ± 3°C (77°F ± 5°F)
Operating temperature range	Discharge	-15°C ~ 55°C (5°F ~ 131°F)
	Charge	-10°C ~ 55°C (14°F ~ 131°F)
	Storage	-20°C ~ 55°C (-4°F ~ 131°F)
Float charging voltage(25°C)		13.50 to 13.80V Temperature compensation: -18mV/°C
Cyclic charging voltage(25°C)		14.10 to 14.40V Temperature compensation: -30mV/°C
Maximum charging current		4.8A
Terminal material		Copper
Maximum discharge current		240 A(5 sec.)
Designed floating life(20°C)		10 years

- ◆ Gelled electrolyte technology;
- ◆ PVC separator;
- ◆ Recognized by UL & CE;
- ◆ ABS container.

### Constant Current Discharge Characteristics (A, 25°C)

F.V/TIME	15min	30min	60min	2h	3h	4h	5h	6h	8h	10h	20h	48h	120h
9.60V	32.4	22.4	14.0	8.16	5.76	4.53	3.79	3.24	2.52	2.25	1.23	---	---
9.90V	31.7	21.9	13.7	8.11	5.71	4.51	3.77	3.21	2.49	2.24	1.23	----	---
10.2V	30.5	21.2	13.5	8.04	5.69	4.47	3.75	3.19	2.49	2.24	1.21	0.54	---
10.5V	29.5	20.8	13.1	7.92	5.64	4.44	3.72	3.17	2.46	2.23	1.20	0.53	0.22
10.8V	27.9	20.0	12.7	7.73	5.47	4.29	3.60	3.07	2.40	2.21	1.20	0.53	0.22

### Constant Power Discharge Characteristics (Watt, 25°C)

F.V/TIME	15min	30min	60min	2h	3h	4h	5h	6h	8h	10h	20h	48h	120h
9.60V	361	255	161	95.1	67.9	53.5	45.1	38.4	30.0	26.9	14.8	---	---
9.90V	353	249	159	94.3	67.7	53.3	44.9	38.1	30.0	26.9	14.8	----	---
10.2V	340	243	155	93.6	67.2	52.8	44.4	37.9	29.7	26.8	14.7	6.42	---
10.5V	328	236	152	92.1	66.7	52.5	44.1	37.7	29.5	26.7	14.5	6.39	2.67
10.8V	311	228	147	89.7	64.5	50.9	42.9	36.5	28.5	26.4	14.5	6.39	2.64

Note: The above characteristics data can be obtained within three charge/discharge cycles.

### Dimensions

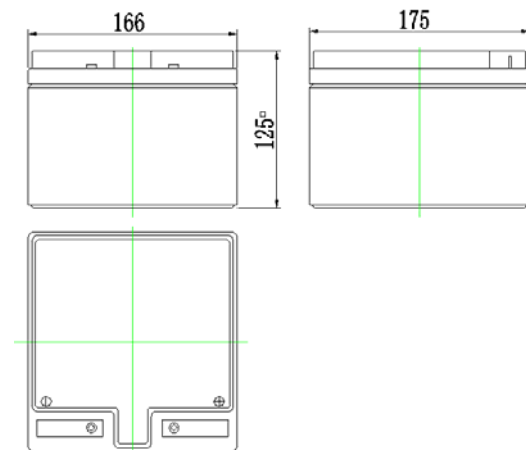

### Terminal

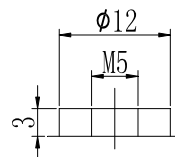

Terminal T8

## Discharge Characteristics(25°C)

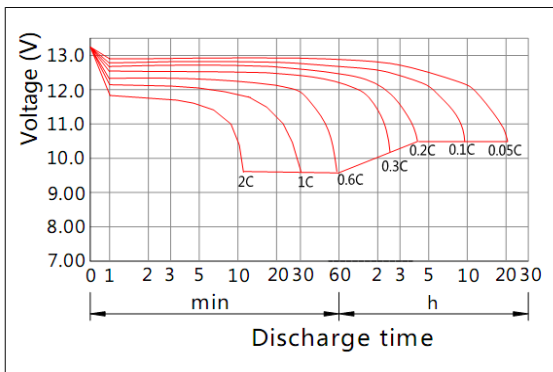

## Charging Characteristics(25°C)

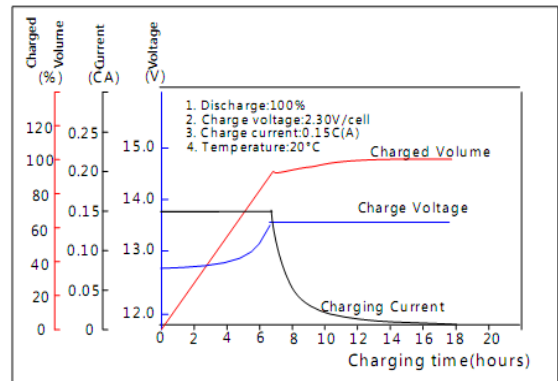

## Effect of Temperature on Capacity

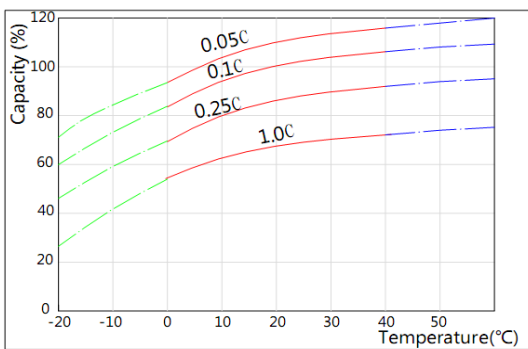

## Self-discharge Characteristics

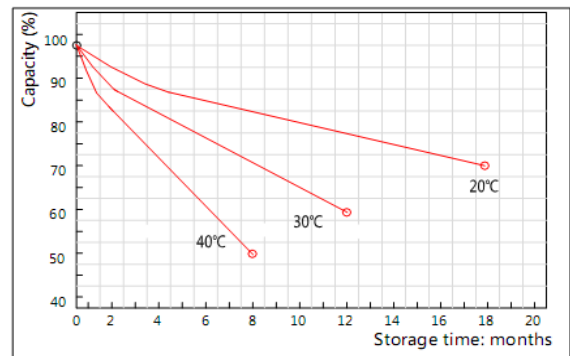

## The Relationship for Open Circuit Voltage and Residual Capacity (25°C)

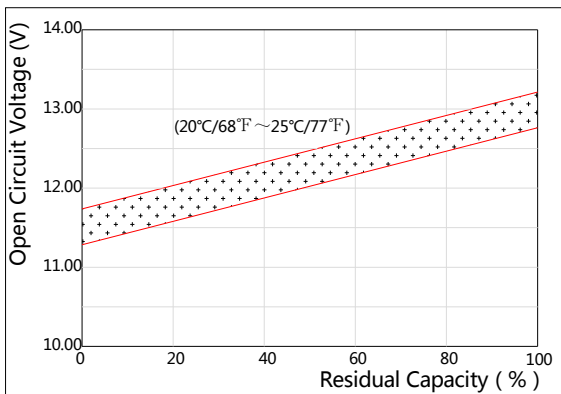

## The Relationship for Charging Voltage and Temperature

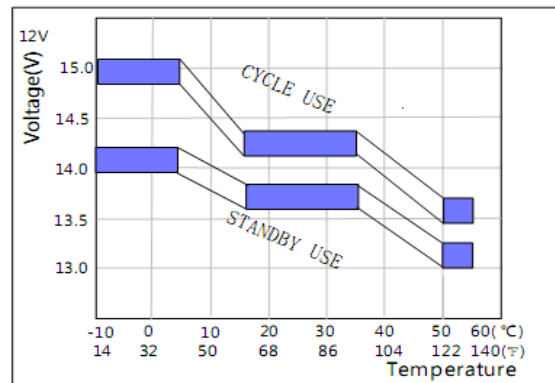

## Floating Life on Temperature

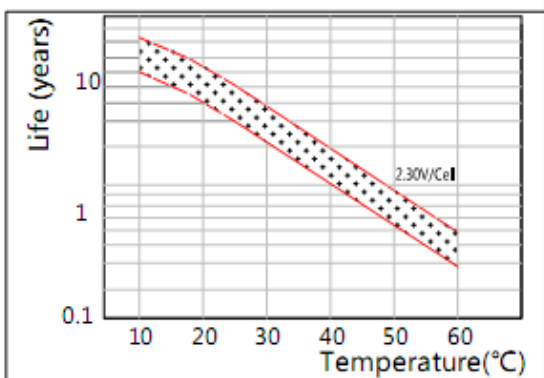

## Cycle Life on D.O.D(25°C)

