

**Specifications**

Nominal Voltage		6 V
Capacity (25°C)	20HR(5.25V)	8.5Ah
	10HR(5.25V)	8.0Ah
	1HR(4.80V)	5.5Ah
Dimension	Length	151 ± 1.5mm (5.94inch)
	Width	34 ± 1mm (1.34inch)
	Height	94 ± 1mm (3.70inch)
	Total Height	100 ± 1mm (3.94inch)
Approx. Weight		1.35kg (3.0lbs) ± 5%
Terminal type		T1/T2
Internal resistance (Fully charged, 25°C)		Approx. 8m Ω
Capacity affected by temperature (20HR)	40°C	102%
	25°C	100%
	0°C	85%
	-15°C	65%
Self-discharge (25°C)	3 month	Remaining Capacity: 91%
	6 month	Remaining Capacity: 82%
	12 month	Remaining Capacity: 65%
Nominal operating temperature		25°C ± 3°C (77°F ± 5°F)
Operating temperature range	Discharge	-15°C ~ 50°C (5°F ~ 122°F)
	Charge	-10°C ~ 50°C (14°F ~ 122°F)
	Storage	-20°C ~ 50°C (-4°F ~ 122°F)
Float charging voltage(25°C)		6.80 to 6.90V Temperature compensation: -9mV/°C
Cyclic charging voltage(25°C)		7.25 to 7.45V Temperature compensation: -15mV/°C
Maximum charging current		2.5A
Terminal material		Copper
Maximum discharge current		135A(5 sec.)
Designed floating life(20°C)		12years

- ◆ Absorbent glass mat technology;
- ◆ Recognized by UL & CE;
- ◆ ABS container.

**Constant Current Discharge Characteristics (A, 25°C)**

F.V/TIME	5min	10min	15min	30min	60min	2h	3h	4h	5h	10h	20h
4.80V	32.3	20.4	16.2	9.01	5.53	3.02	2.17	1.73	1.47	0.81	0.431
4.95V	31.3	19.8	15.8	8.83	5.44	3.00	2.15	1.72	1.47	0.81	0.430
5.10V	30.0	19.0	15.2	8.56	5.30	2.98	2.14	1.71	1.46	0.80	0.428
5.25V	28.7	18.2	14.7	8.35	5.20	2.93	2.13	1.70	1.45	0.80	0.425
5.40V	27.1	17.1	13.9	8.05	5.04	2.86	2.06	1.65	1.40	0.79	0.417

**Constant Power Discharge Characteristics (Watt, 25°C)**

F.V/TIME	5min	10min	15min	30min	60min	2h	3h	4h	5h	10h	20h
4.80V	180	115	92.1	51.6	32.0	17.7	12.9	10.3	8.80	4.81	2.59
4.95V	175	112	89.8	50.6	31.5	17.6	12.8	10.3	8.75	4.80	2.58
5.10V	168	107	86.5	49.0	30.7	17.4	12.7	10.2	8.69	4.77	2.57
5.25V	160	102	83.6	47.9	30.1	17.1	12.6	10.1	8.63	4.74	2.55
5.40V	151	96.6	79.2	46.1	29.2	16.7	12.2	9.82	8.37	4.65	2.50

Note: The above characteristics data can be obtained within three charge/discharge cycles.

**Dimensions**

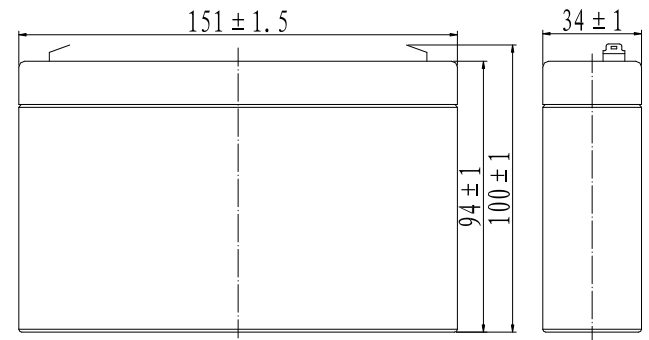

**Terminal**

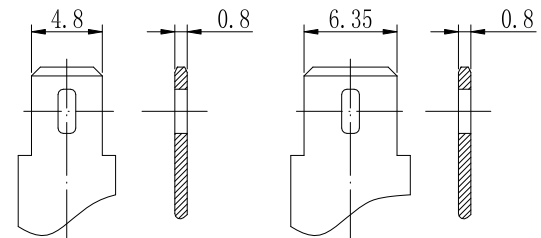

Terminal T1

Terminal T2

**Discharge Characteristics(25°C)**

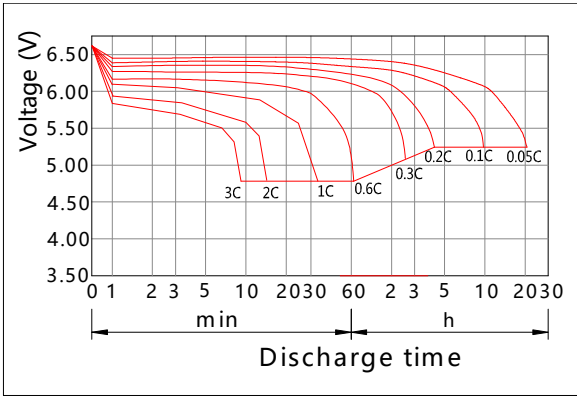

**Charging Characteristics(25°C)**

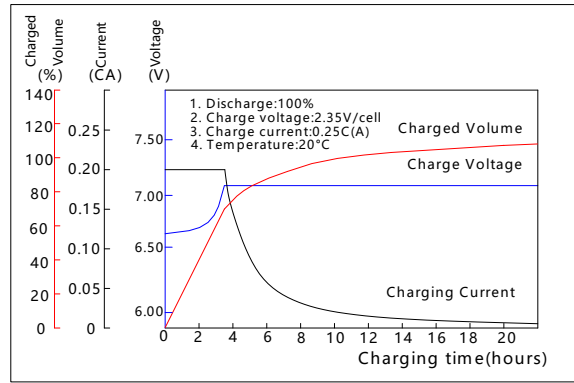

**Effect of Temperature on Capacity**

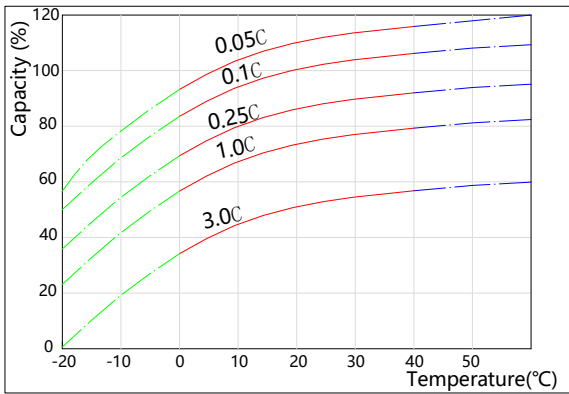

**Self-discharge Characteristics**

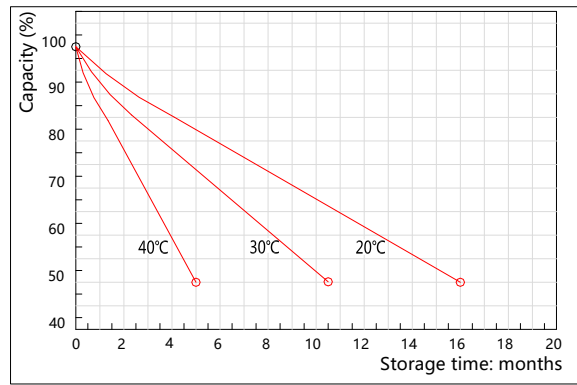

**The Relationship for Open Circuit Voltage and Residual Capacity (25°C)**

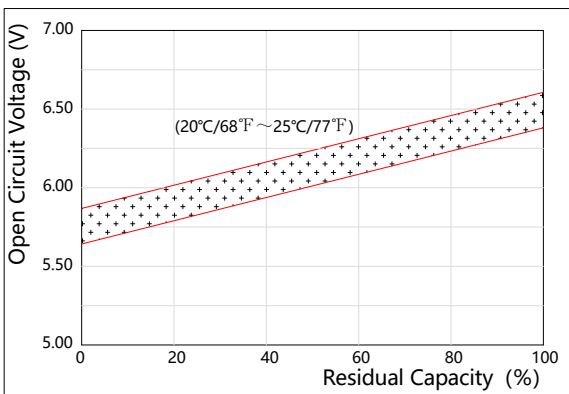

**The Relationship for Charging Voltage and Temperature**

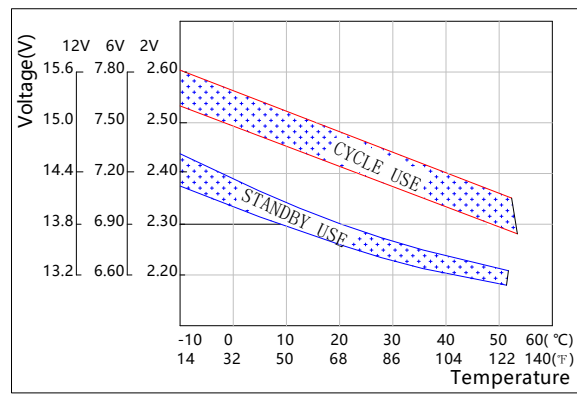

**Floating Life on Temperature**

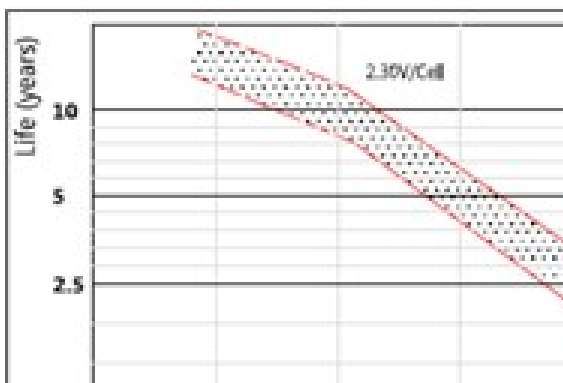

**Cycle Life on D.O.D(25°C)**

