

**Specifications**

Nominal Voltage		12 V
Capacity (25°C)	20HR(10.5V)	28 Ah
	10HR(10.5V)	26Ah
	1HR(9.60V)	17.6Ah
Dimension	Length	166±2mm (6.54inch)
	Width	175±2mm (6.89inch)
	Height	125±2mm (4.92inch)
	Total Height	125±2mm (4.92inch)
Approx. Weight		8.6kg (19.0lbs)±4%
Terminal type		T3/T8
Internal resistance (Fully charged, 25°C)		Approx. 10mΩ
Capacity affected by temperature (20HR)	40°C	102%
	25°C	100%
	0°C	85%
	-15°C	65%
Self-discharge (25°C)	3 month	Remaining Capacity: 91%
	6 month	Remaining Capacity: 82%
	12 month	Remaining Capacity: 65%
Nominal operating temperature		25°C ± 3°C (77°F ± 5°F)
Operating temperature range	Discharge	-15°C ~ 50°C (5°F ~ 122°F)
	Charge	-10°C ~ 50°C (14°F ~ 122°F)
	Storage	-20°C ~ 50°C (-4°F ~ 122°F)
Float charging voltage(25°C)	13.60 to 13.80V Temperature compensation: -18mV/°C	
Cyclic charging voltage(25°C)	14.50 to 14.90V Temperature compensation: -30mV/°C	
Maximum charging current	8.4A	
Terminal material	Copper	
Maximum discharge current	420A(5 sec.)	
Designed floating life(20°C)	10years	

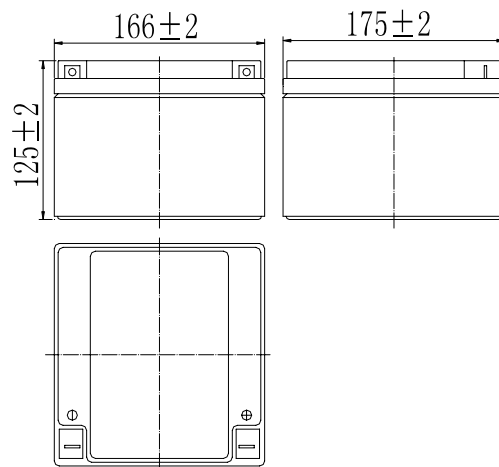

**Dimensions**



**Terminal**

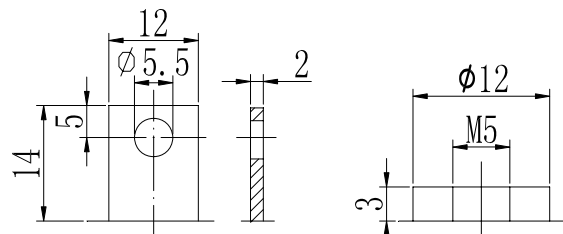

Terminal T3

Terminal T8

- ◆ Absorbent glass mat technology;
- ◆ Recognized by UL & CE;
- ◆ ABS container.

**Constant Current Discharge Characteristics (A, 25°C)**

F.V/TIME	10min	15min	30min	60min	2h	3h	4h	5h	8h	10h	20h
9.60V	64.8	51.3	28.6	17.6	9.95	7.14	5.71	4.86	3.14	2.64	1.42
9.90V	62.9	50.1	28.0	17.3	9.89	7.10	5.68	4.83	3.12	2.63	1.42
10.2V	60.3	48.2	27.2	16.8	9.80	7.05	5.64	4.79	3.10	2.62	1.41
10.5V	57.7	46.6	26.5	16.5	9.65	7.00	5.60	4.76	3.08	2.60	1.40
10.8V	54.4	44.1	25.6	16.0	9.41	6.79	5.43	4.62	2.99	2.55	1.37

**Constant Power Discharge Characteristics (Watt, 25°C)**

F.V/TIME	10min	15min	30min	60min	2h	3h	4h	5h	8h	10h	20h
9.60V	731	585	328	203	116	84.8	68.0	58.0	37.7	31.7	17.1
9.90V	709	571	321	200	116	84.3	67.6	57.6	37.5	31.6	17.0
10.2V	680	550	312	195	115	83.7	67.2	57.2	37.2	31.4	16.9
10.5V	651	531	304	191	113	83.2	66.7	56.8	37.0	31.2	16.8
10.8V	614	503	293	185	110	80.7	64.7	55.1	35.9	30.6	16.5

Note: The above characteristics data can be obtained within three charge/discharge cycles.

**Discharge Characteristics(25°C)**

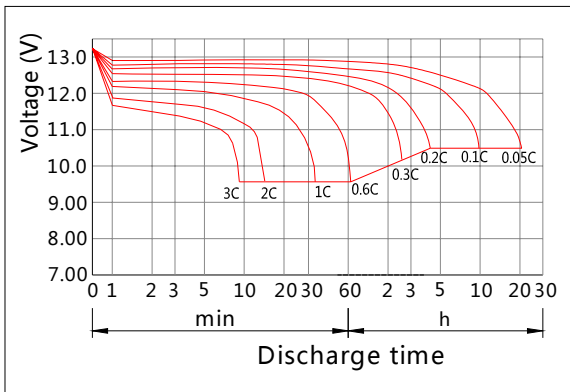

**Charging Characteristics(25°C)**

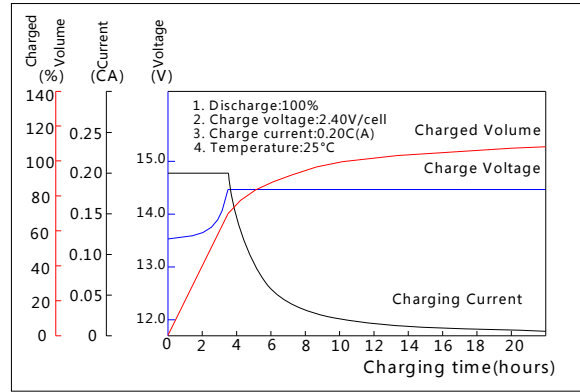

**Effect of Temperature on Capacity**

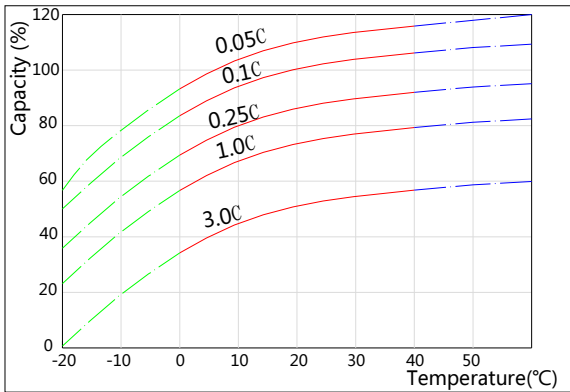

**Self-discharge Characteristics**

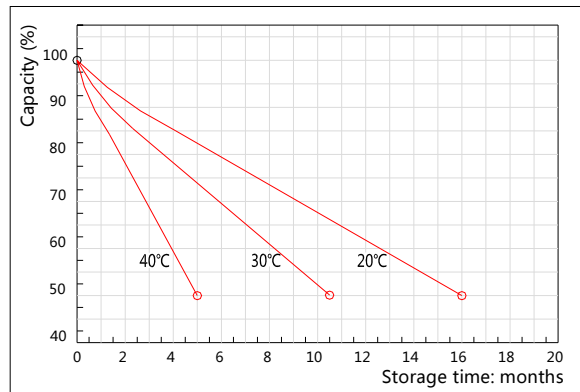

**The Relationship for Open Circuit Voltage and Residual Capacity (25°C)**

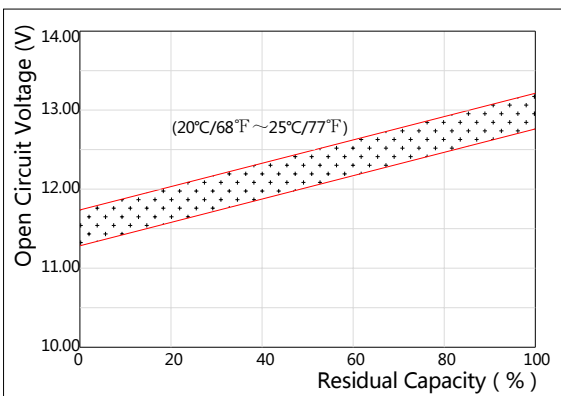

**The Relationship for Charging Voltage and Temperature**

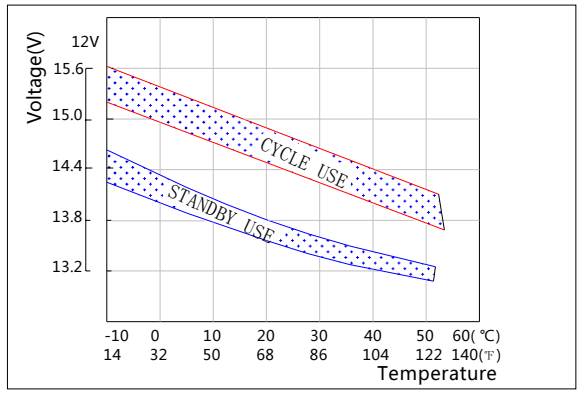

**Floating Life on Temperature**

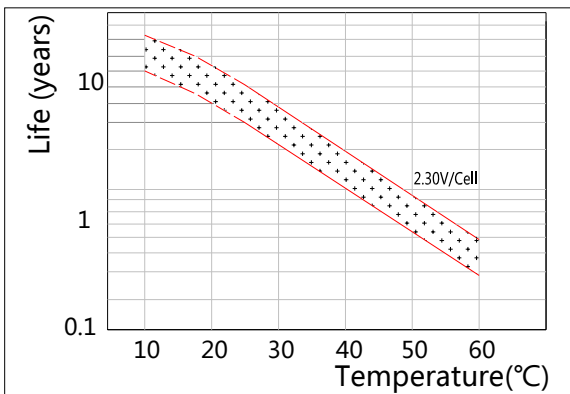

**Cycle Life on D.O.D(25°C)**

