

Specifications

Nominal Voltage		6 V
Capacity (25°C)	20HR(5.25V)	8Ah
	10HR(5.25V)	7.4Ah
	1HR(4.80V)	5.2Ah
Dimension	Length	98 ± 1mm (3.86inch)
	Width	56 ± 1mm (2.20inch)
	Height	117 ± 1mm (4.61inch)
	Total Height	119 ± 1mm (4.69inch)
Approx. Weight		1.2kg (2.65lbs) ± 5%
Terminal type		T1
Internal resistance (Fully charged, 25°C)		Approx. 10mΩ
Capacity affected by temperature (20HR)	40°C	102%
	25°C	100%
	0°C	85%
	-15°C	65%
Self-discharge (25°C)	3 month	Remaining Capacity: 91%
	6 month	Remaining Capacity: 82%
	12 month	Remaining Capacity: 65%
Nominal operating temperature		25°C ± 3°C (77°F ± 5°F)
Operating temperature range	Discharge	-15°C ~ 50°C (5°F ~ 122°F)
	Charge	-10°C ~ 50°C (14°F ~ 122°F)
	Storage	-20°C ~ 50°C (-4°F ~ 122°F)
Float charging voltage(25°C)		6.80 to 6.90V Temperature compensation: -9mV/°C
Cyclic charging voltage(25°C)		7.25 to 7.45V Temperature compensation: -15mV/°C
Maximum charging current		2.4A
Terminal material		Copper
Maximum discharge current		120A(5 sec.)
Designed floating life(20°C)		10years

- ◆ Absorbent glass mat technology;
- ◆ Recognized by UL & CE;
- ◆ ABS container.

Constant Current Discharge Characteristics (A, 25°C)

F.V/TIME	5min	10min	15min	30min	60min	2h	3h	4h	5h	10h	20h
4.80V	30.4	19.2	15.2	8.48	5.20	2.84	2.04	1.63	1.39	0.76	0.41
4.95V	29.5	18.6	14.8	8.31	5.12	2.83	2.03	1.62	1.38	0.75	0.40
5.10V	28.3	17.9	14.3	8.06	4.99	2.80	2.01	1.61	1.37	0.75	0.40
5.25V	27.1	17.1	13.8	7.86	4.89	2.76	2.00	1.60	1.36	0.74	0.40
5.40V	25.5	16.1	13.1	7.57	4.74	2.69	1.94	1.55	1.32	0.73	0.39

Constant Power Discharge Characteristics (Watt, 25°C)

F.V/TIME	5min	10min	15min	30min	60min	2h	3h	4h	5h	10h	20h
4.80V	170	108	86.6	48.6	30.1	16.6	12.1	9.72	8.28	4.53	2.44
4.95V	165	105	84.6	47.6	29.7	16.5	12.0	9.66	8.23	4.51	2.43
5.10V	158	101	81.4	46.2	28.9	16.4	12.0	9.59	8.18	4.49	2.41
5.25V	151	96.4	78.7	45.0	28.3	16.1	11.9	9.53	8.12	4.46	2.40
5.40V	142	91.0	74.5	43.4	27.5	15.7	11.5	9.24	7.88	4.37	2.35

Note: The above characteristics data can be obtained within three charge/discharge cycles.

Dimensions

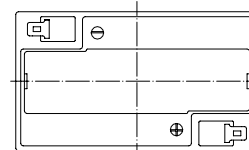
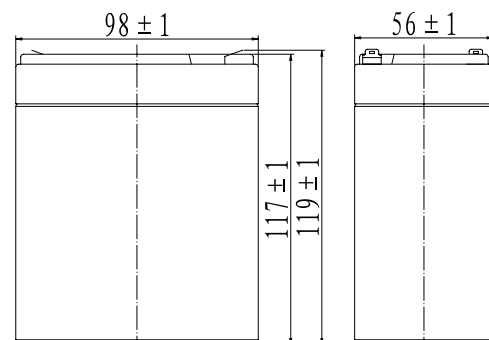

Terminal

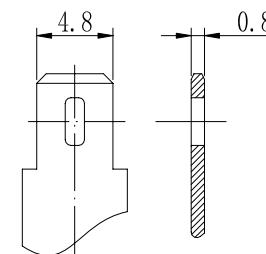

Terminal T1

Discharge Characteristics(25°C)

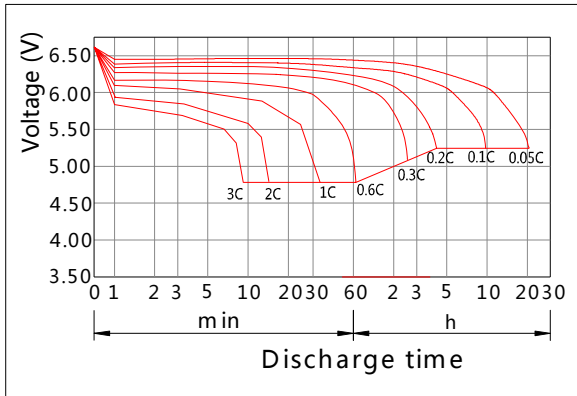

Charging Characteristics(25°C)

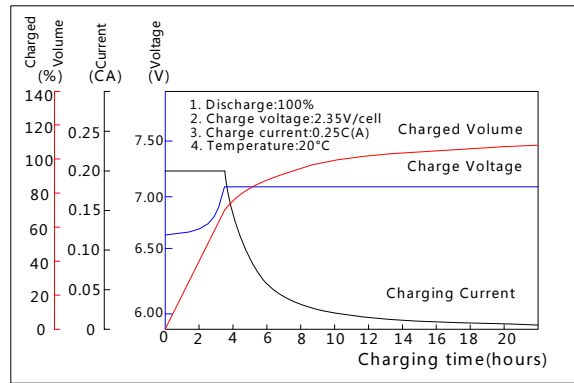

Effect of Temperature on Capacity

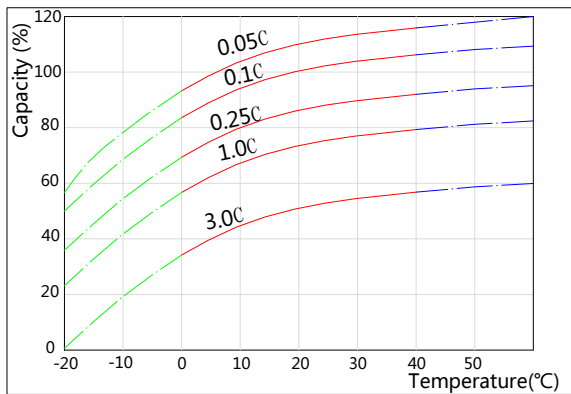

Self-discharge Characteristics

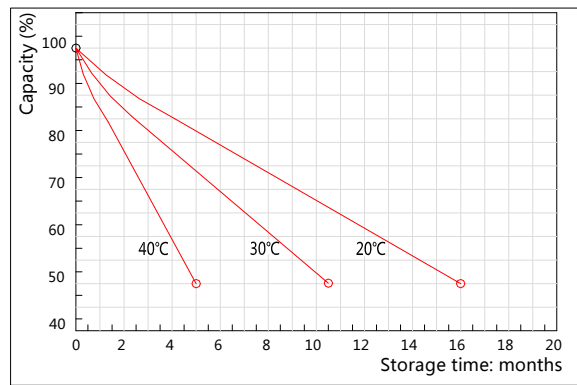

The Relationship for Open Circuit Voltage and Residual Capacity (25°C)

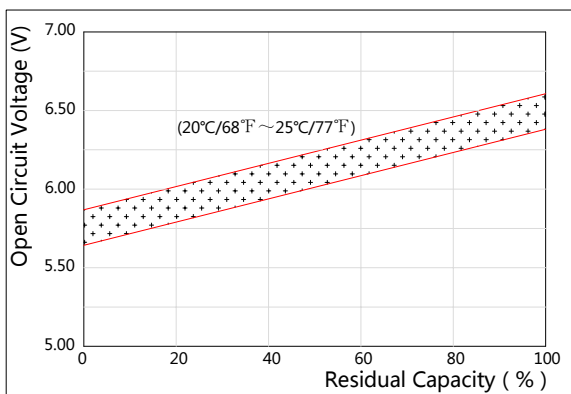

The Relationship for Charging Voltage and Temperature

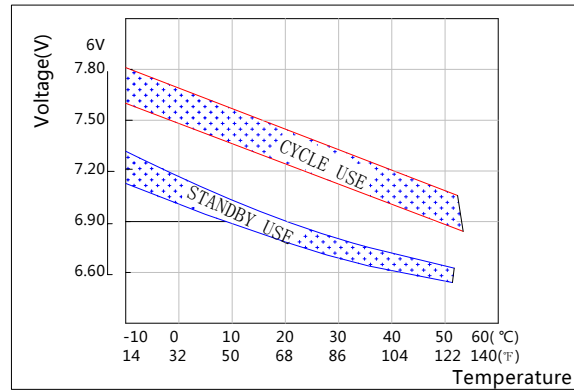

Floating Life on Temperature

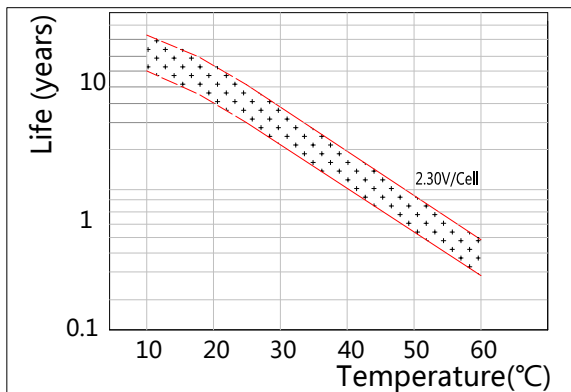

Cycle Life on D.O.D(25°C)

